

# Mixed Material

## Writing Desk

style # 8820307T

DPCI # 249-05-9132

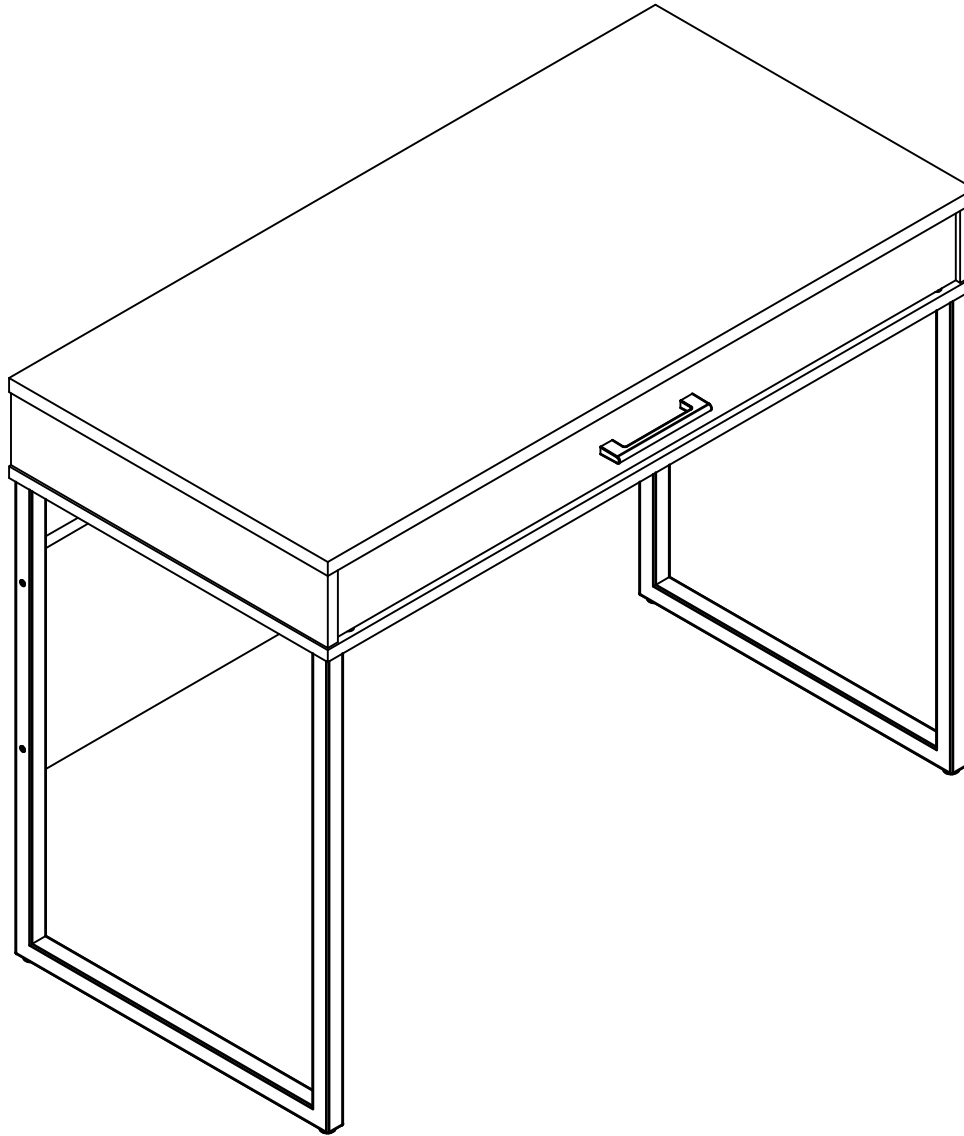

>> assembly instructions

B348820000T01



- Congratulations on your latest Target purchase.  
Now what? Don't start sweating over the box of parts. This will be easy. We did the hard work for you. All you need to do is follow our simple instructions and you'll be on your way to transforming your room in no time. Good luck--- though we're confident you won't need it.

## before you begin

1. Check for damaged or missing parts. Call 1-855-MYTGTHOME (855-698-4846) to order missing supplies.
2. Use the carton as a working surface to prevent product damage during assembly.
3. Gather all tools prior to assembly. Please do not use power tools.

## tools needed

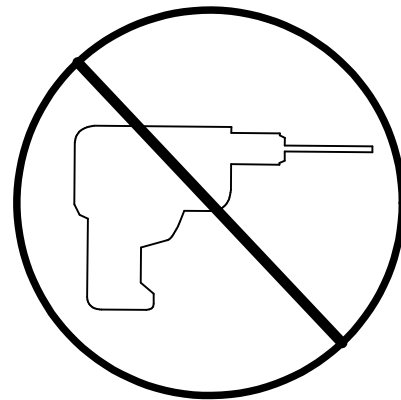
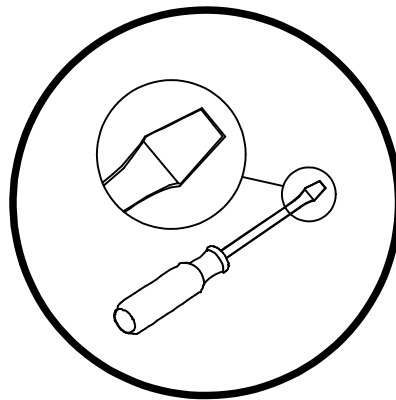
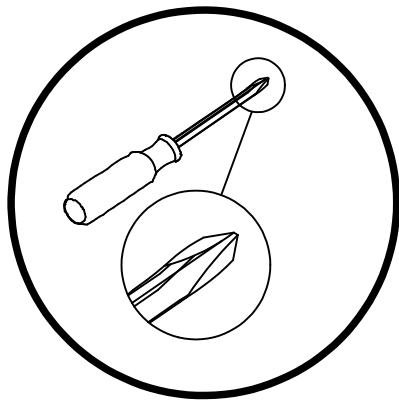
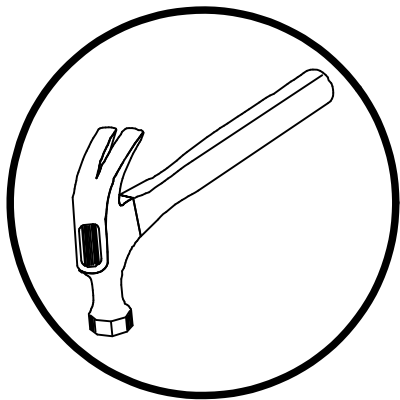

# table of contents

---

introduction	2
hardware	4-5
parts list	6
how to use the cam lock system	7
assembly	8-22

**QUESTIONS?** Just call 1-855-MYTGTHOME (855-698-4846) for parts and service. For faster service, have the style number and DPCI number ready when calling.

# hardware

(1) x6  
cam lock  
#A22620



(2) x6  
cam bolt  
#A22610

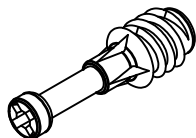

(3) x4  
wood dowel  
#A21660

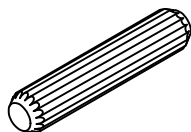

(4) x2  
connector housing  
#A22920 (black)

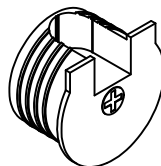

(5) x2  
connector bolt  
#A22910

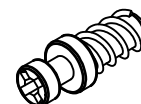

(6) x12  
M6 machine screw  
#A20650

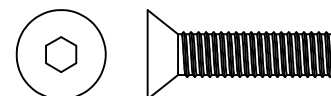

(7) x6  
drive fastener  
#A21970

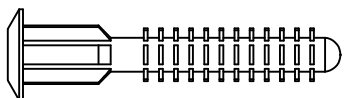

(8) x4  
#8x7/16" pan head screw  
#A12120

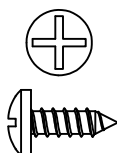

(9) x10  
confirmat screw  
#A23030



(10) x10  
#6x 7/16" flat head screw  
#A11080



(11) x2  
#8-32x7/8" bolt  
#A17400

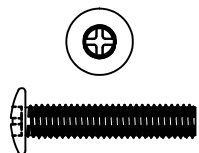

(12) x2  
drawer bracket  
#A54203

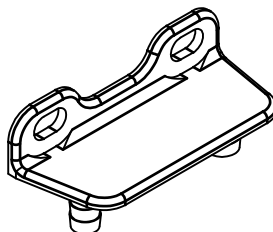

(13) x1  
slide set  
#A56770

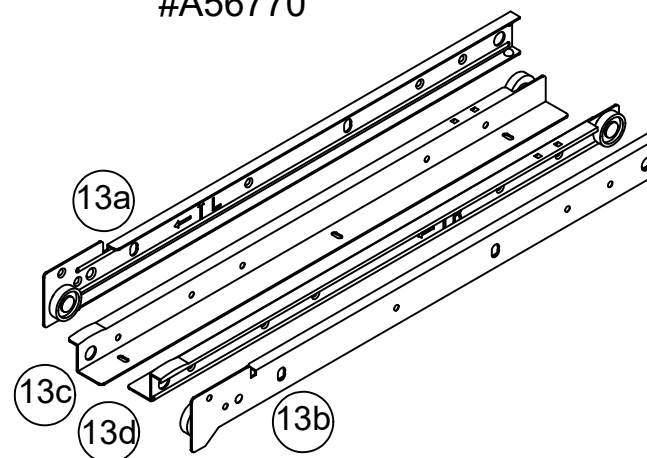

**Note that your unit may contain extra hardware**

# hardware

---

(14) x1  
handle  
#A50415

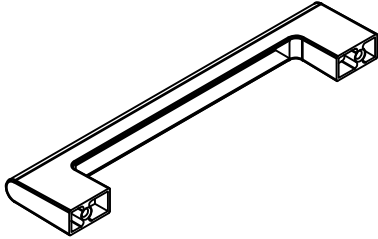

(15) x1  
left metal leg  
#A95510

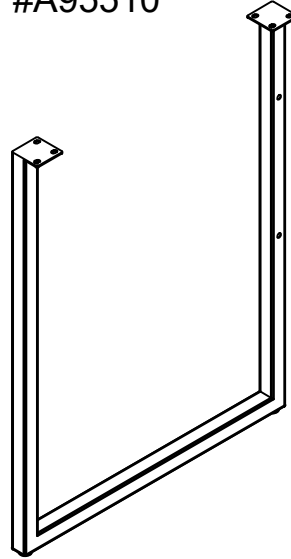

(16) x1  
right metal leg  
#A95520

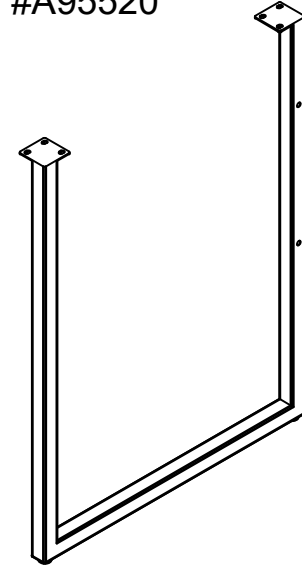

---

(17) x12  
M6 lock nut  
#A19000



(18) x1  
4mm hex key  
#A23100

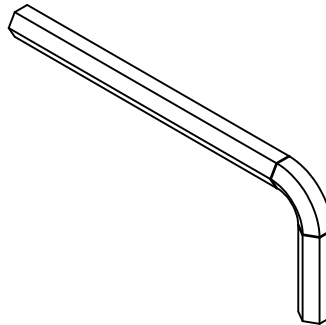

Parts shown are the base cabinet of your model. Please note, most parts are labeled with a sticker or have a letter stamped on a raw edge.

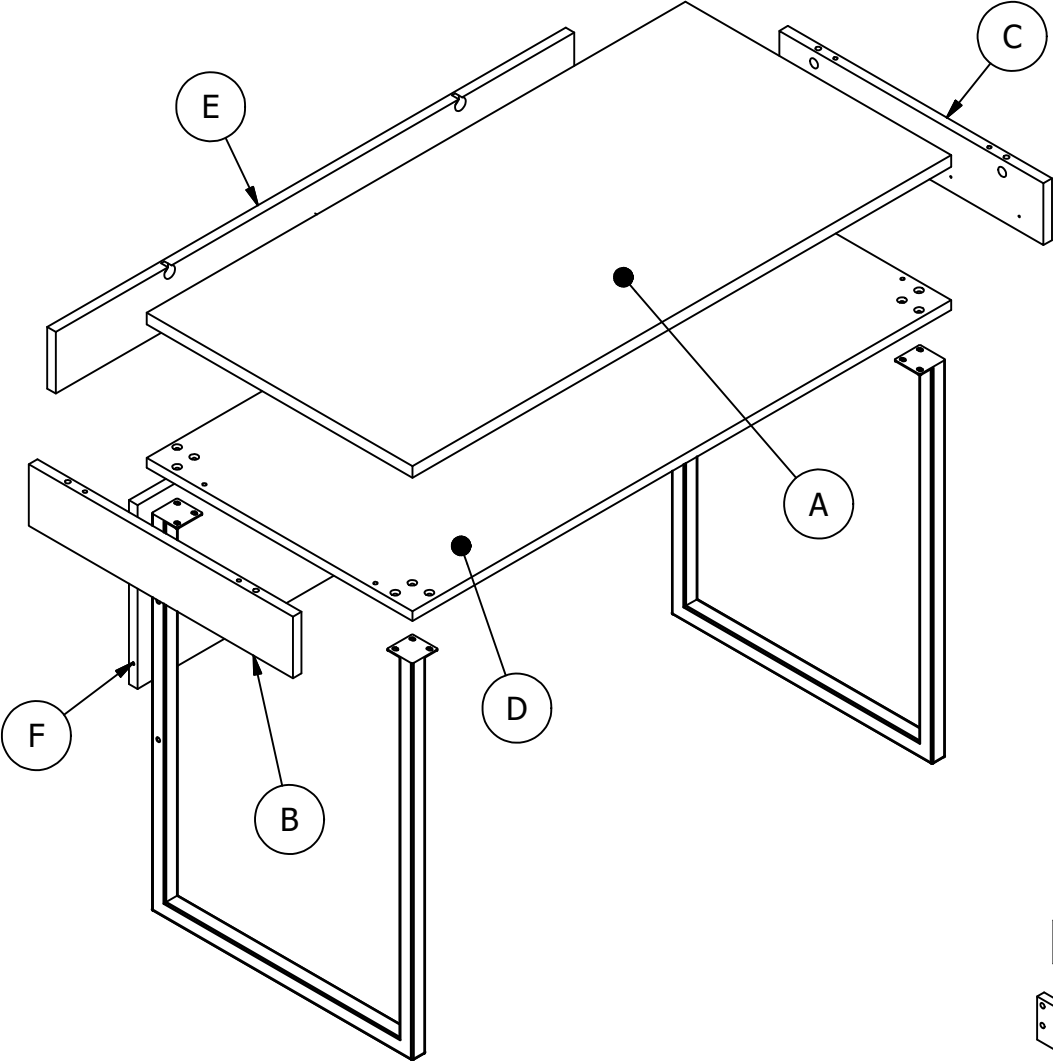

Parts List			
ITEM	QTY	PART NUMBER	DESCRIPTION
A	1	38820307010	TOP
B	1	38820307020	LEFT PANEL
C	1	38820307030	RIGHT PANEL
D	1	38820307041	BOTTOM
E	1	38820000050	BACK PANEL
F	1	38820307060	MODESTY PANEL
G	1	38820307070	DRAWER FRONT
K	1	399900643295100	DRAWER BRACE
	1	39991070346010L	LEFT DRAWER SIDE
	1	39991070346010R	RIGHT DRAWER SIDE
	1	39991070091850B	DRAWER BACK
	1	39991340092910D	DRAWER BOTTOM

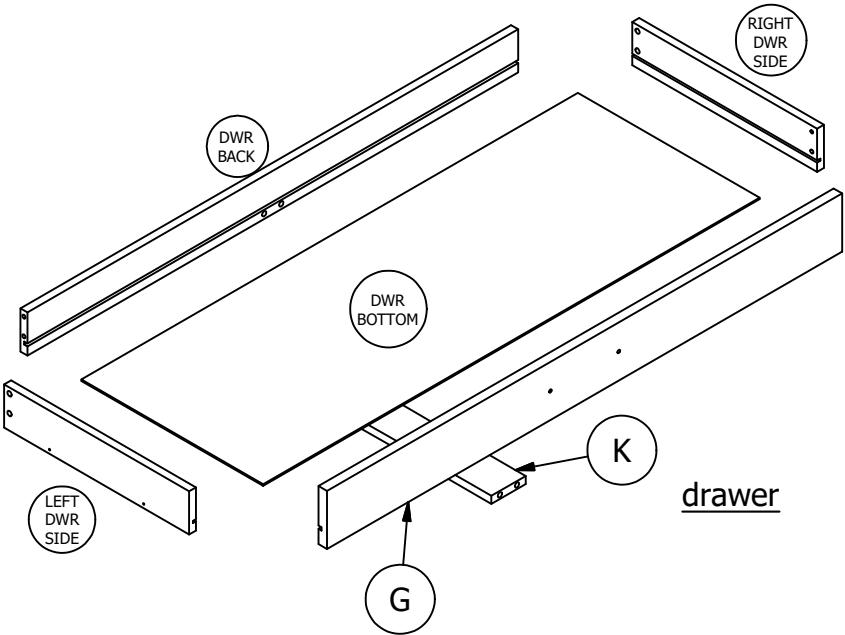

# how to use the cam lock system

---

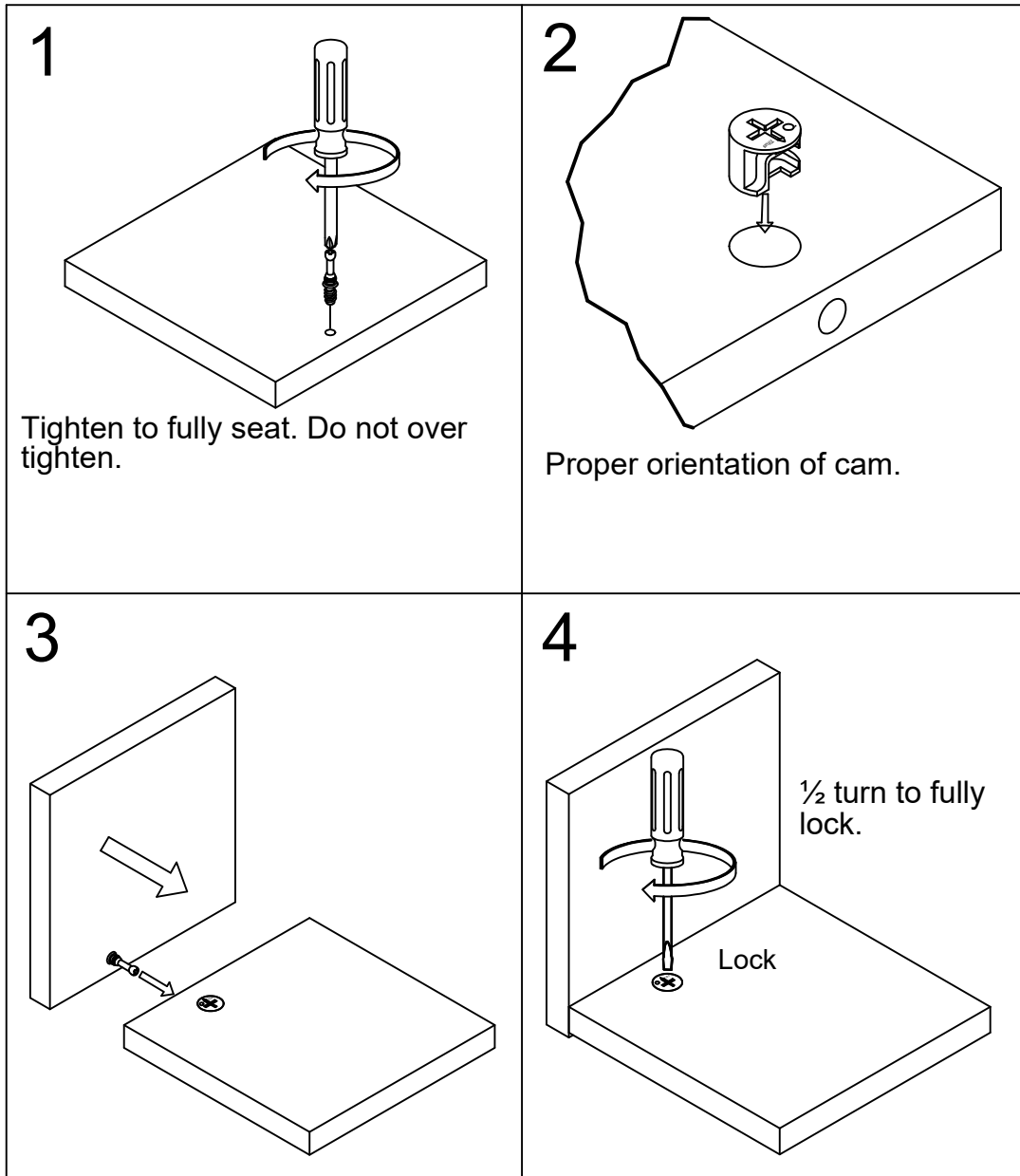

# step 1

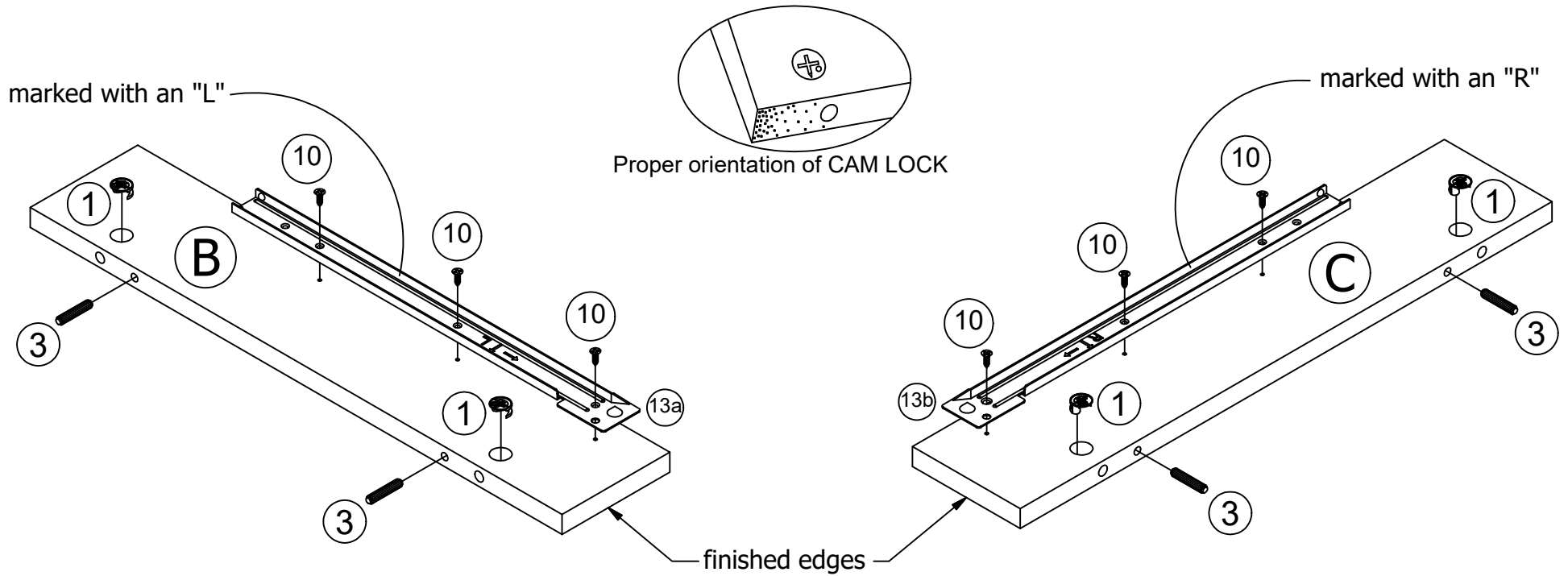

**(1) x4**  
cam lock



**(3) x4**  
wood dowel

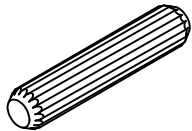

**(10) x6**  
#6x7/16" screw

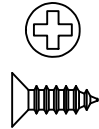

**(13) x1**  
left cabinet slide

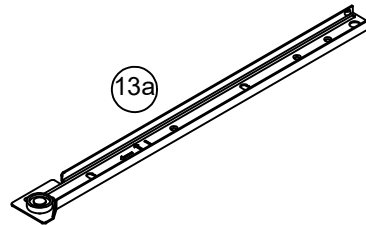

**(13) x1**  
right cabinet slide

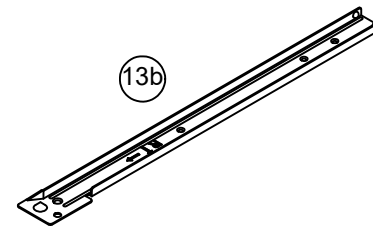

1. Refer to page 7 for instructions on how to use the cam lock system.



## step 2

---

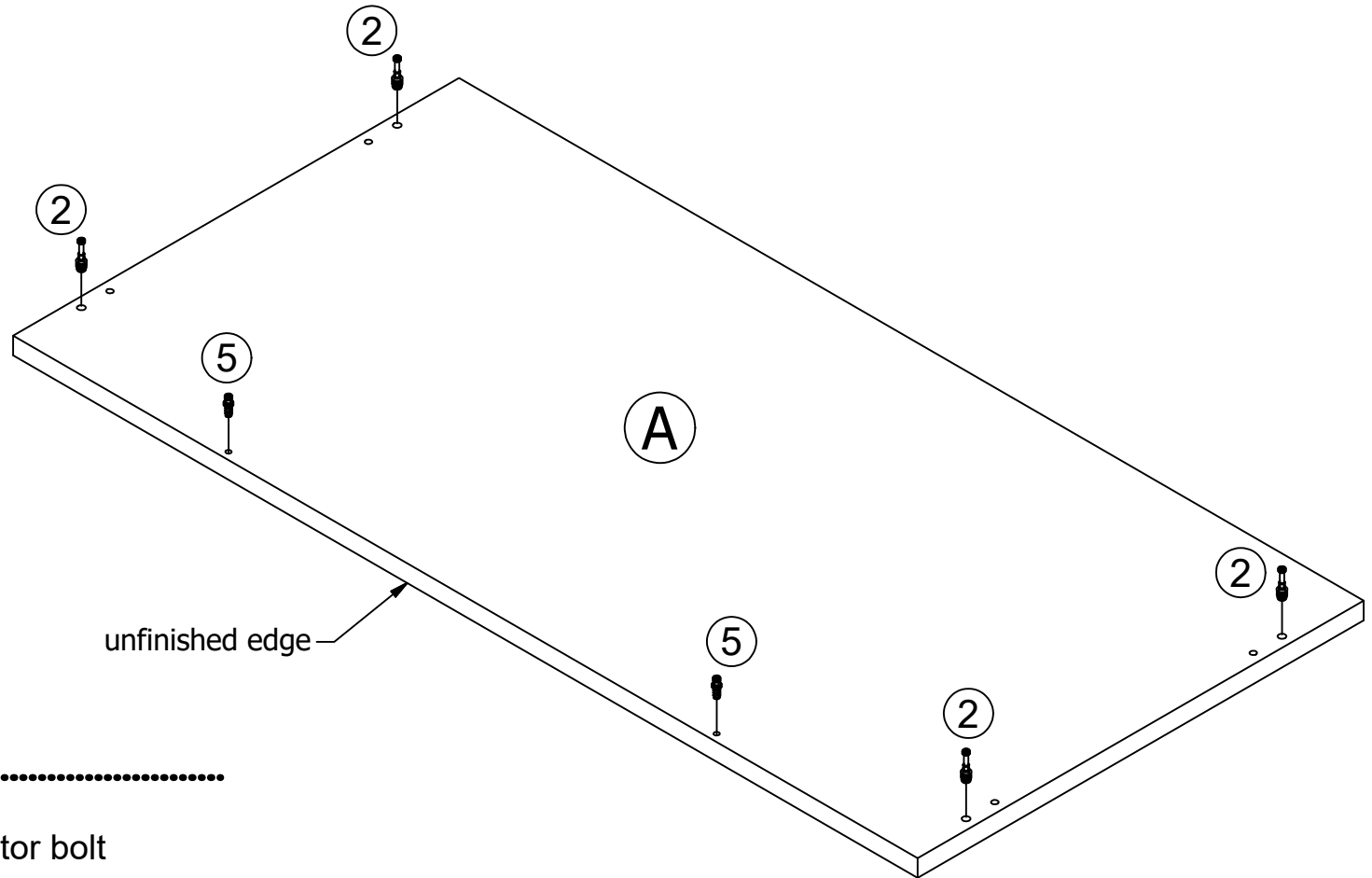
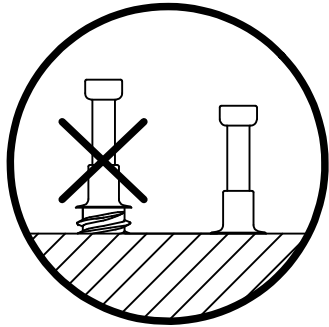

---

**(2) x4**  
cam bolt

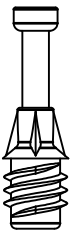

**(5) x2**  
connector bolt

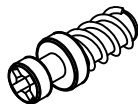

1. Screw-in cam bolts must be screwed down flush.
2. Refer to page 7 for instructions on how to use the cam lock system.

## step 3

---

You will need to tap the connector (4) with a hammer to fully insert. Be sure the connector is positioned as shown before pushing into holes.

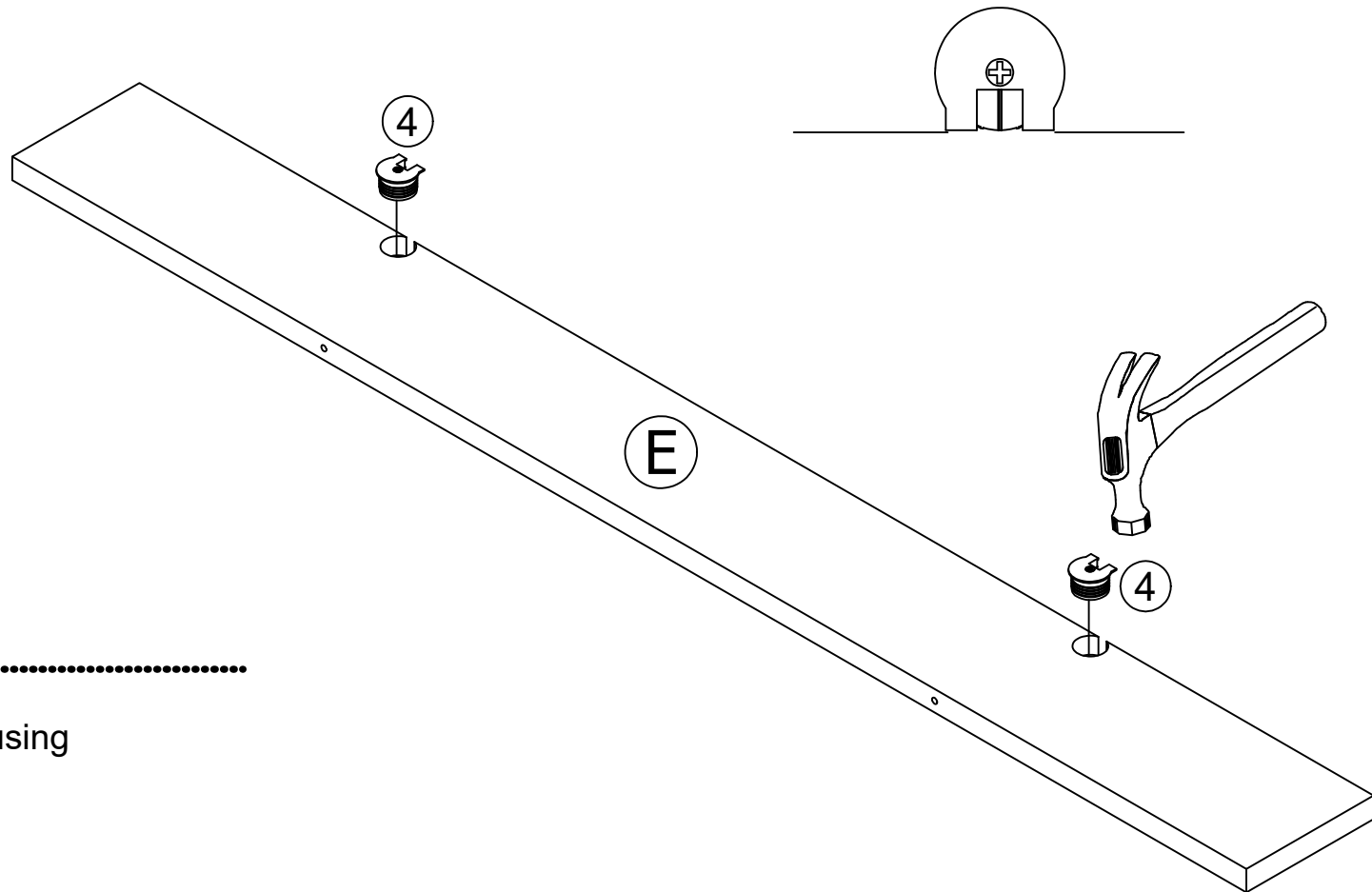

---

(4) x2  
connector housing

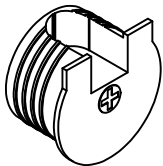

## step 4

---

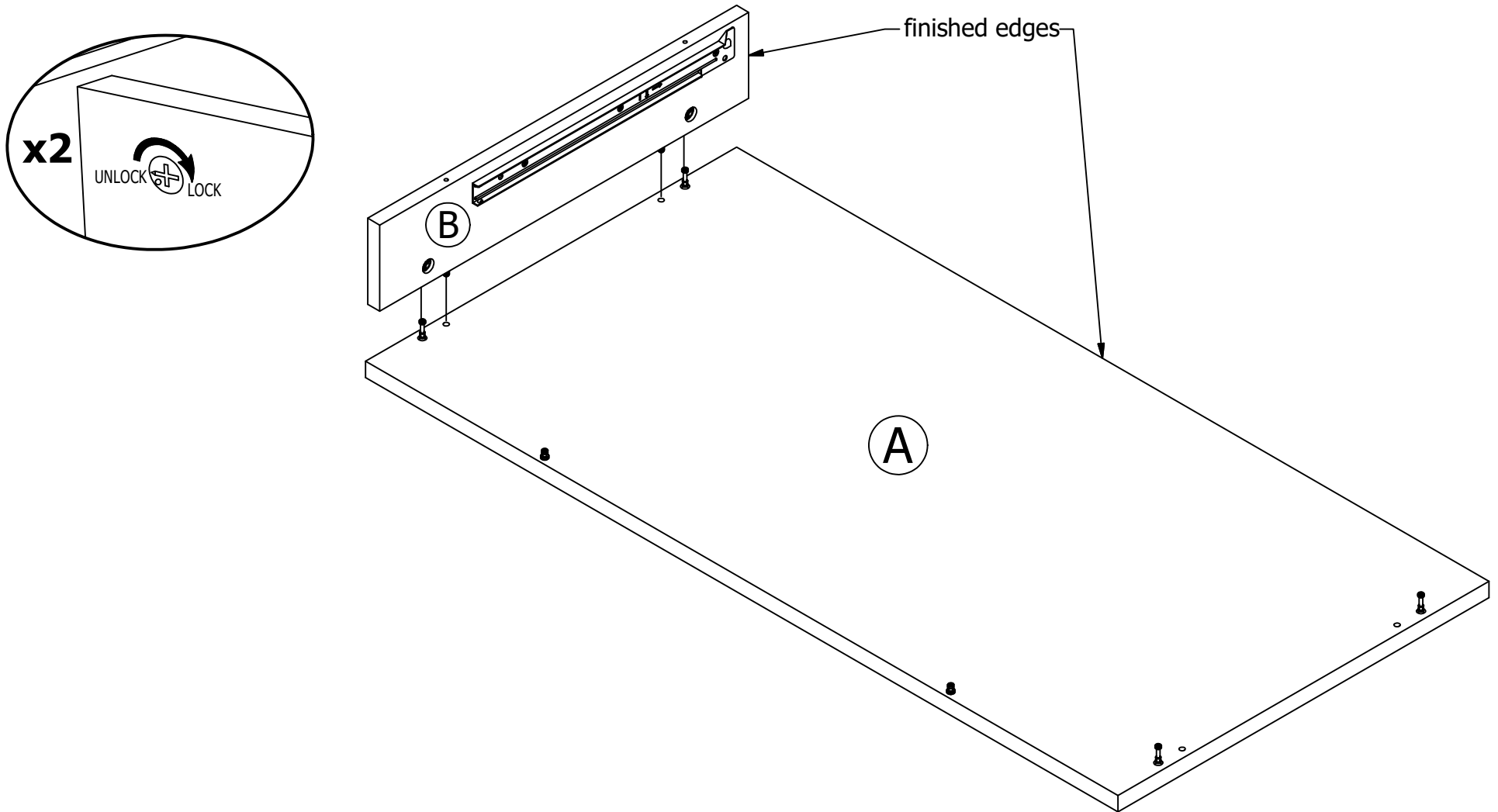

---

1. Refer to page 7 for instructions on how to use the cam lock system.

## step 5

---

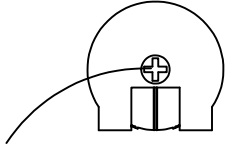

Turn screw clockwise to lock in place.

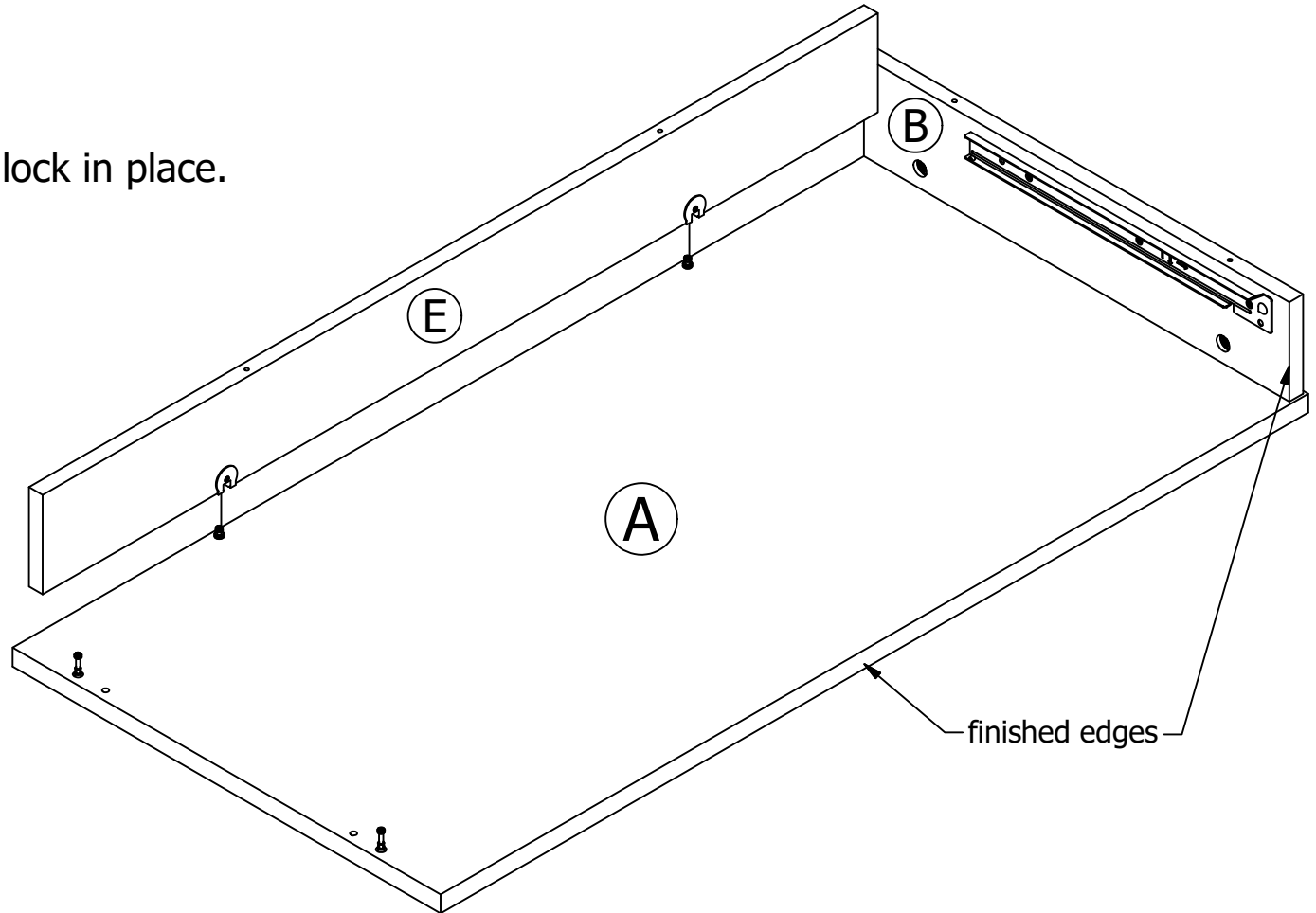



# step 7

---

1. Attach modesty panel (F) to one metal leg (15) or (16) at a time

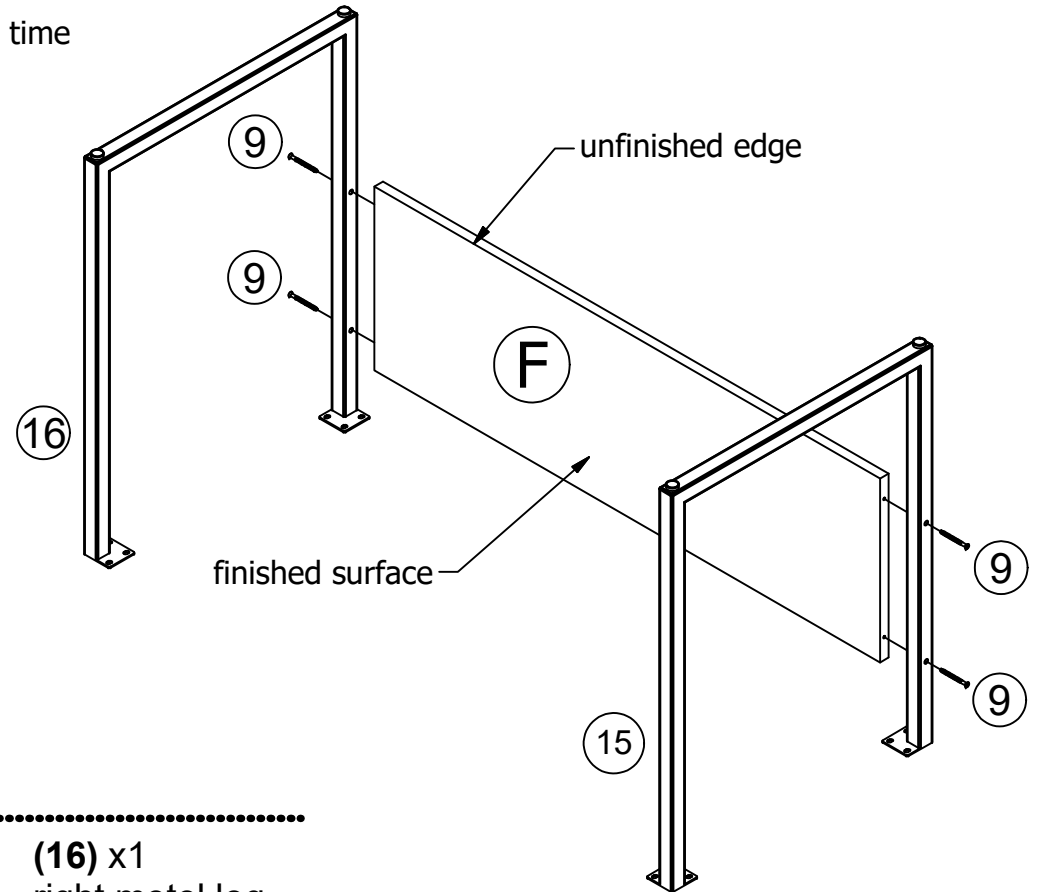

---

**(9)** x4  
confirmat screw



**(15)** x1  
left metal leg

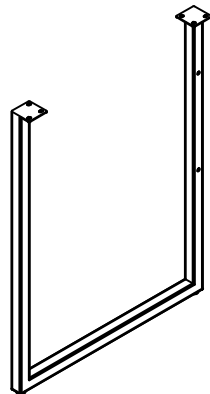

**(16)** x1  
right metal leg

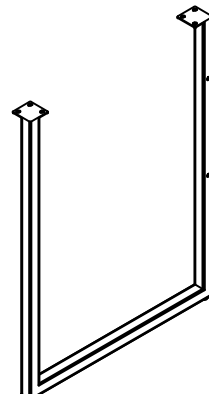

## step 8

1. With the help of another person, using a wrench or vice grips and the hex key (18) furnished, fasten the bottom (D) to the metal legs (15 & 16) with machine screws (6) and lock nuts (17).

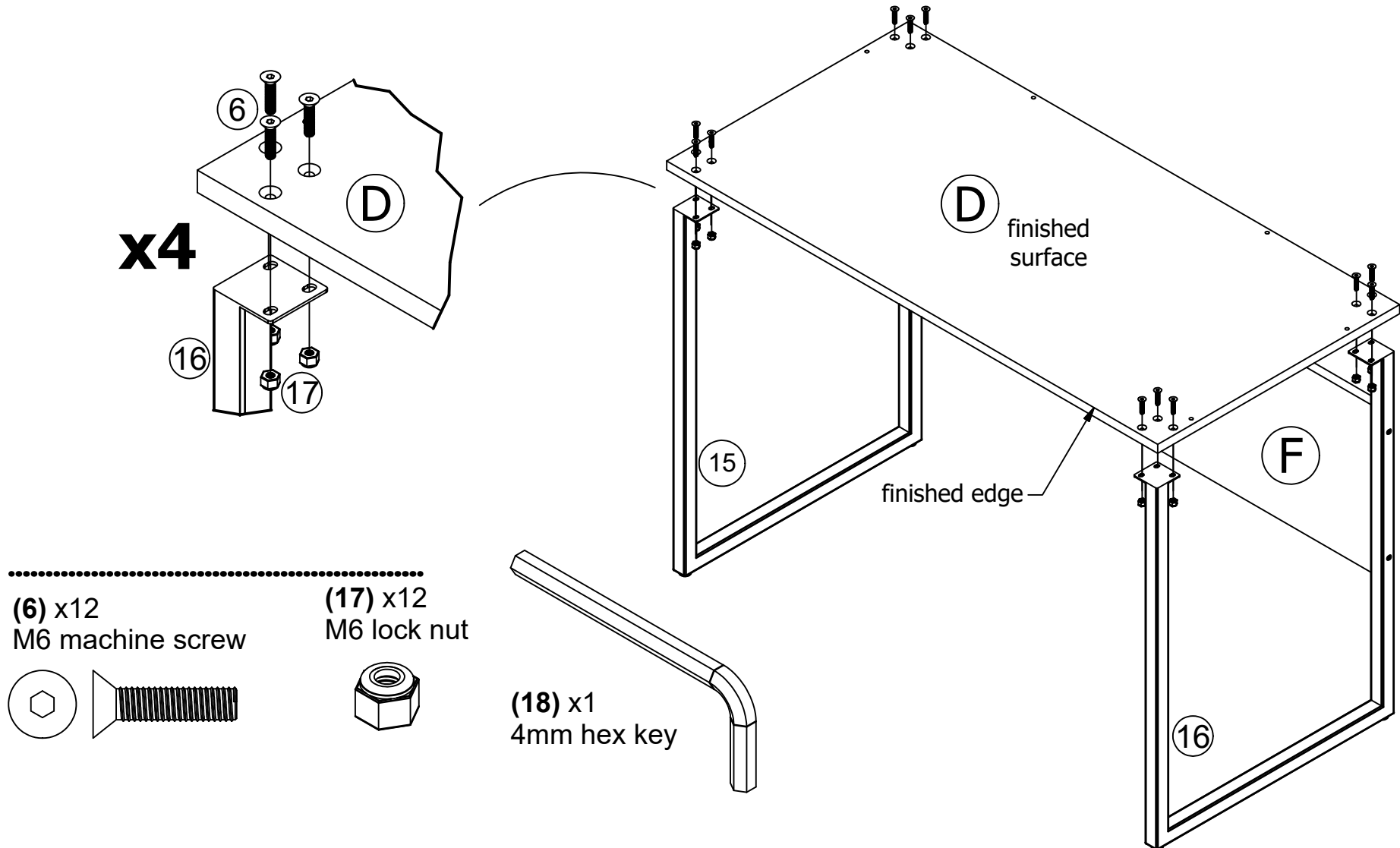

## step 9

---

1. With the help of another person, align holes of bottom (D) with holes in left panel (B), right panel (C), and back panel (E), and fasten with screws (9).

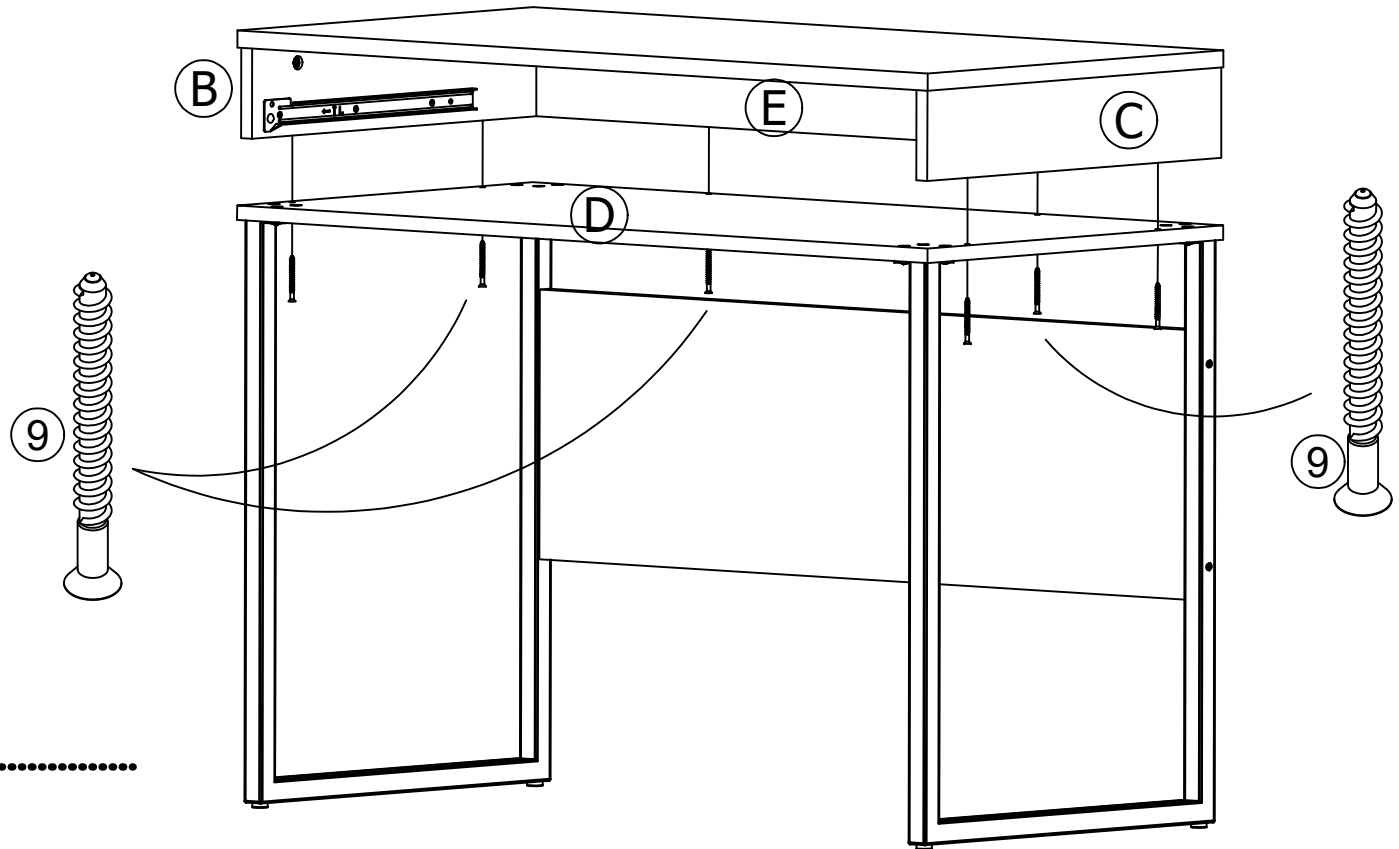

---

(9) x6  
confirmat screw





# step 10

---

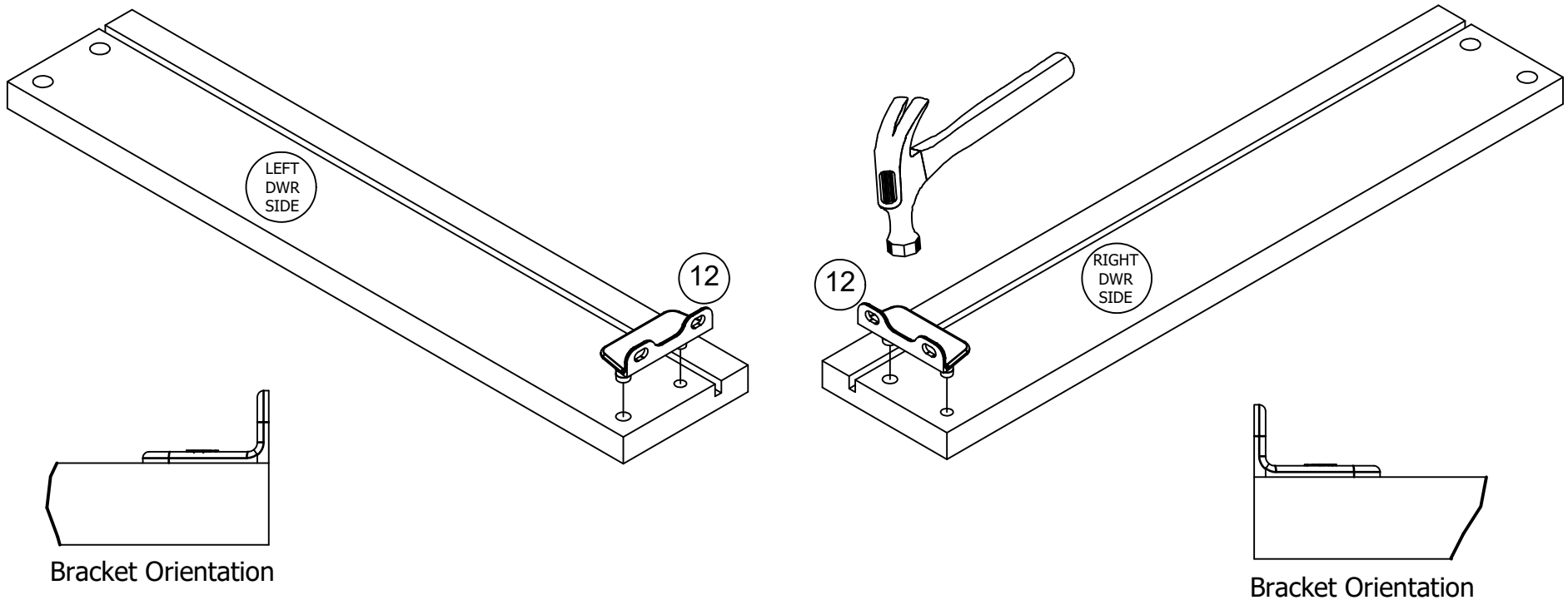

---

(12) x2  
drawer bracket

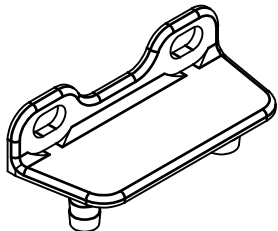

1. Lay the drawer sides down on flat surface. **Carefully line up** the drawer bracket with the holes in the drawer side as shown. Using a hammer, tap each drawer bracket stem part way into each hole. Repeat this process until the drawer bracket is fully seated in the drawer side.

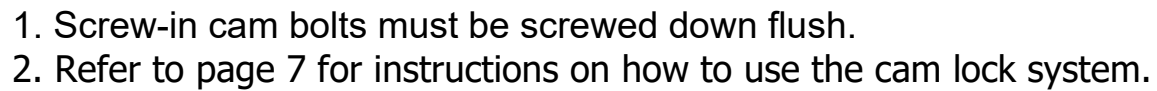

# step 12

---

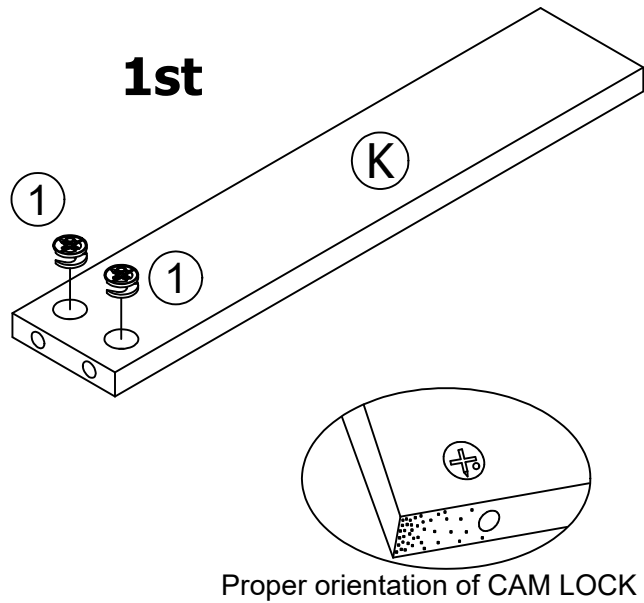

---

(1) x2  
cam lock

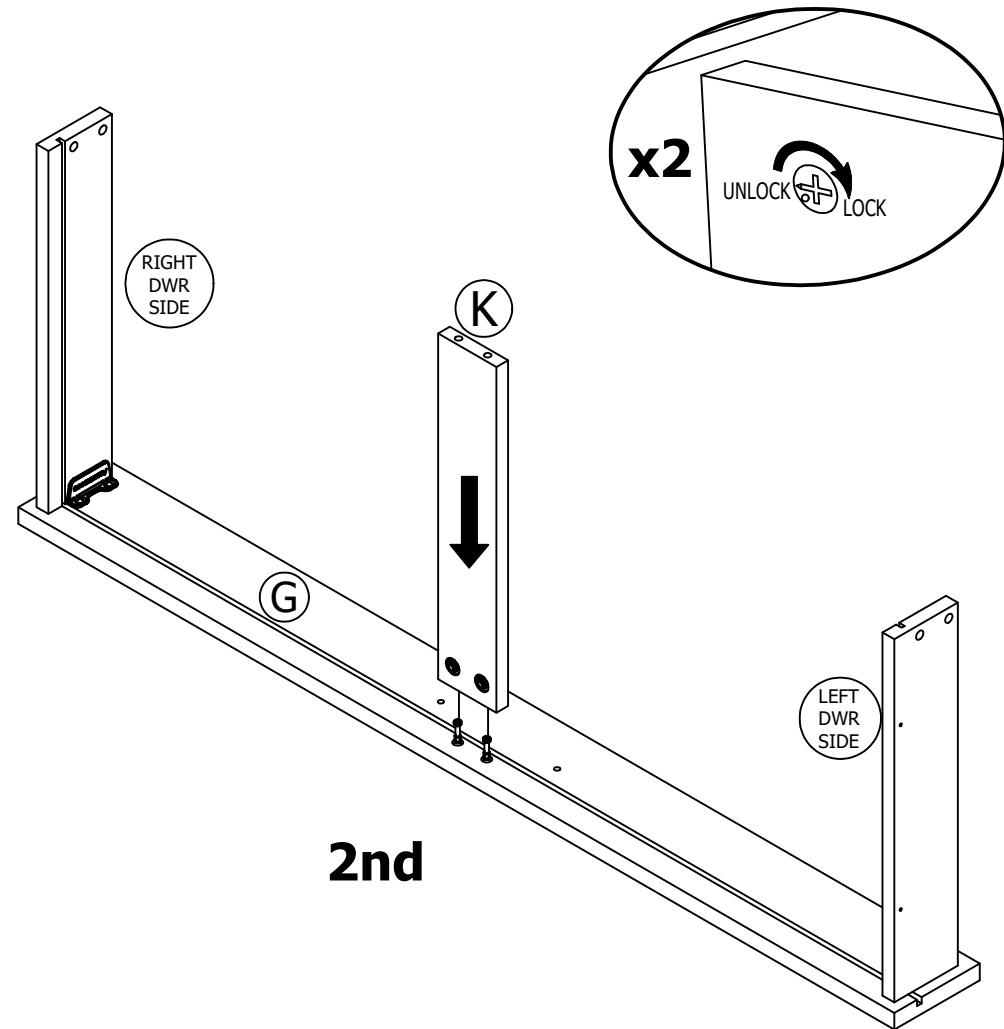

1. Refer to page 7 for instructions on how to use the cam lock system.

# step 13

---

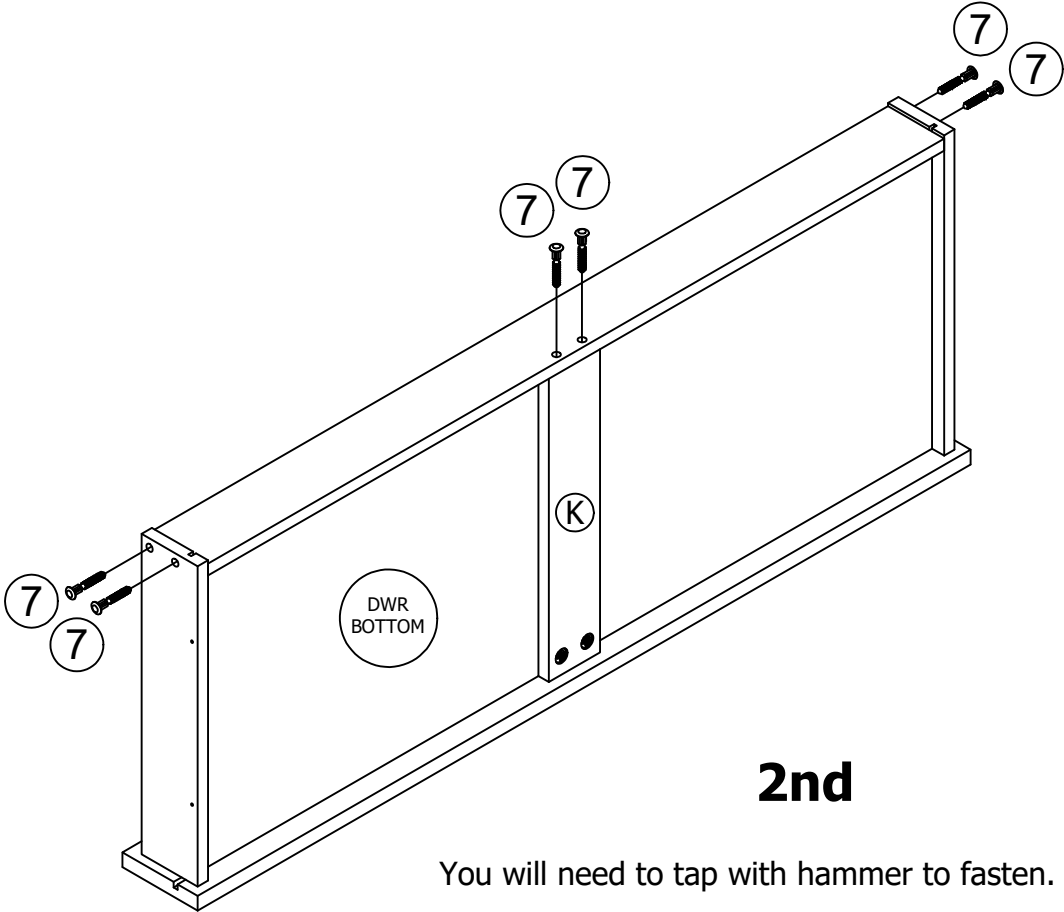
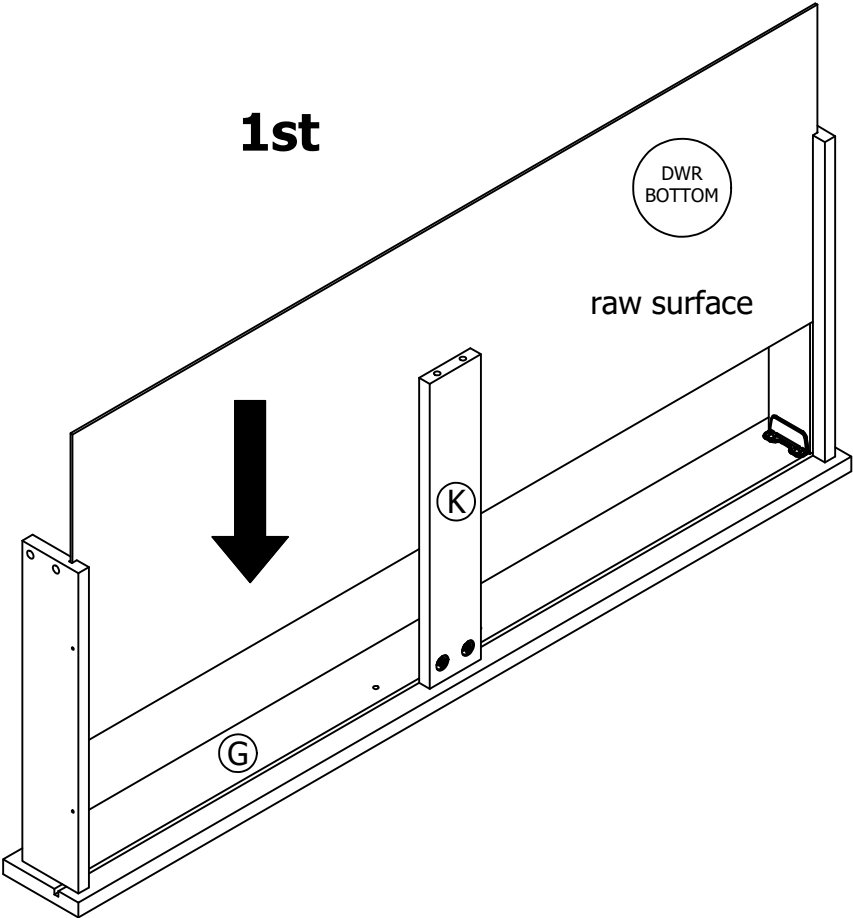

You will need to tap with hammer to fasten.

---

(7) x6  
drive fastener

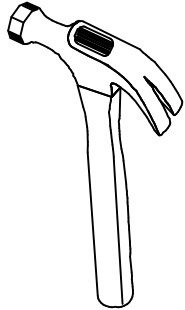
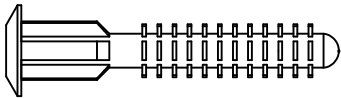

# step 14

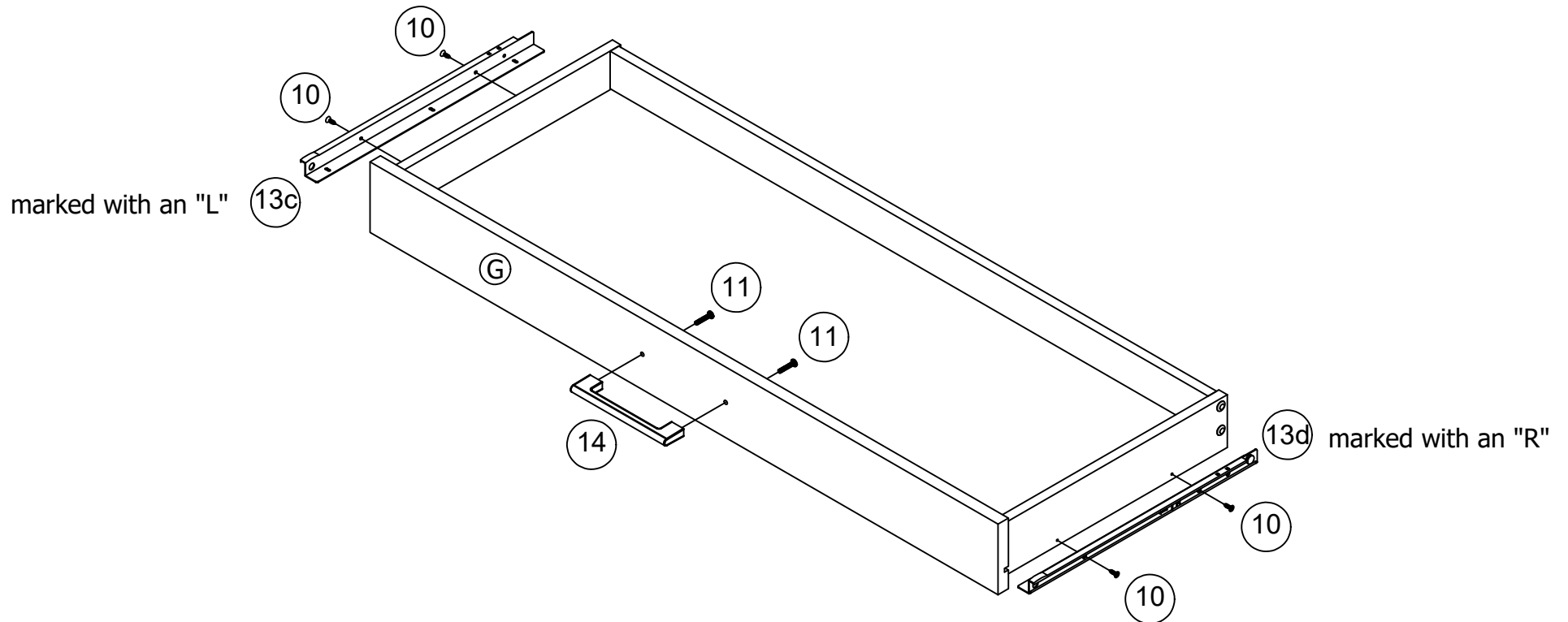

**(10) x4**  
#6x 7/16" flat head screw

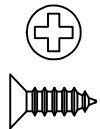

**(11) x2**  
#8-32x7/8" bolt

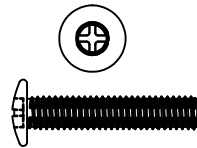

**(13) x1**  
left drawer slide

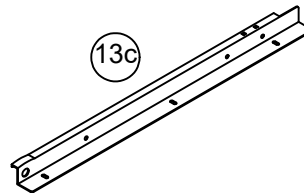

**(13) x1**  
right drawer slide

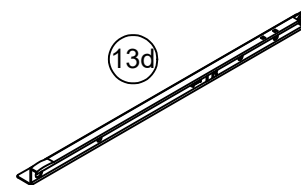

**(14) x1**  
handle

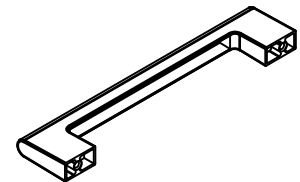

# step 15

---

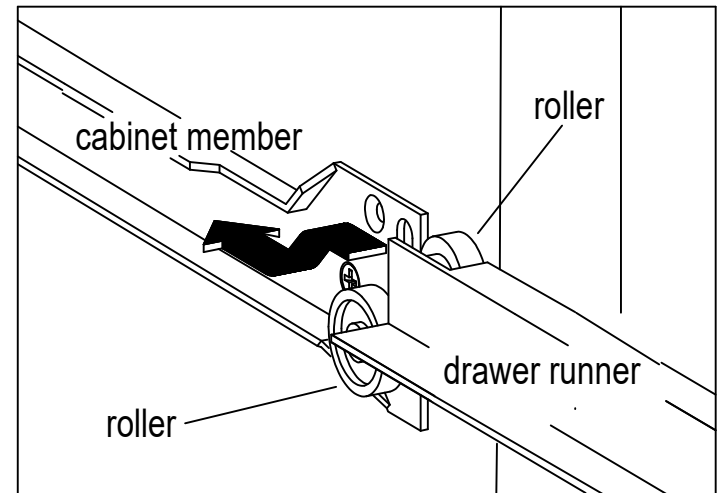
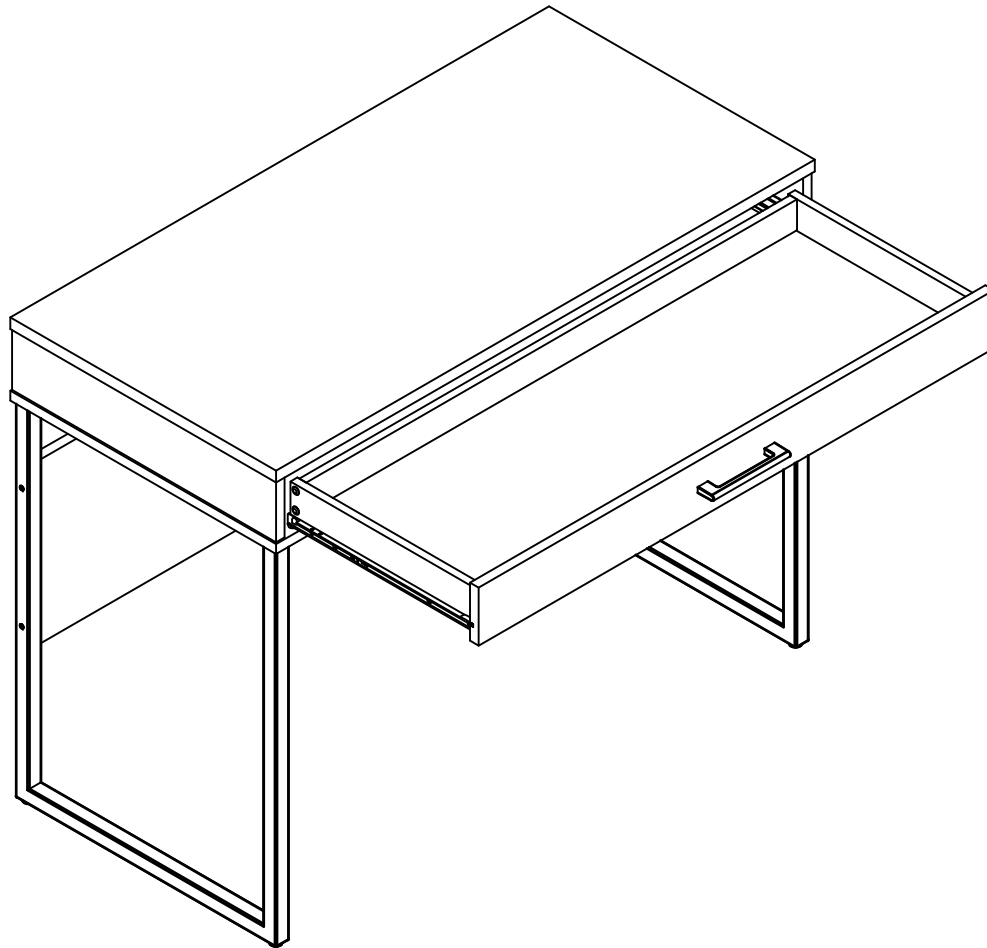

1. Notice, the drawer bracket holes are slotted. Drawer fronts can be adjusted by loosening screws, making needed adjustments and retightening screws.

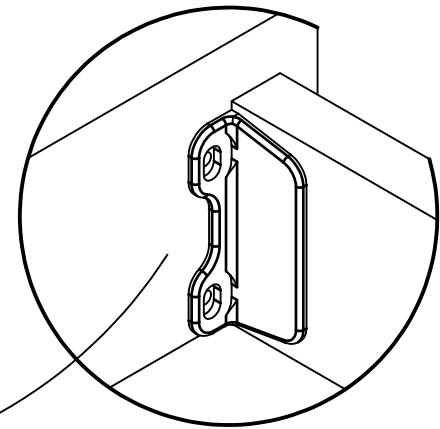

## MAXIMUM LOADS

This unit has been designed to support the maximum loads shown. Exceeding these load limits could cause sagging, instability, product collapse, and/or serious injury.

**Warning: Risk of injury to persons - do not place a television on this furniture. This furniture is not approved for use with a television.**

