

# Mixed Material

## Media Stand

style # 9144307T

DPCI # 249-05-5458

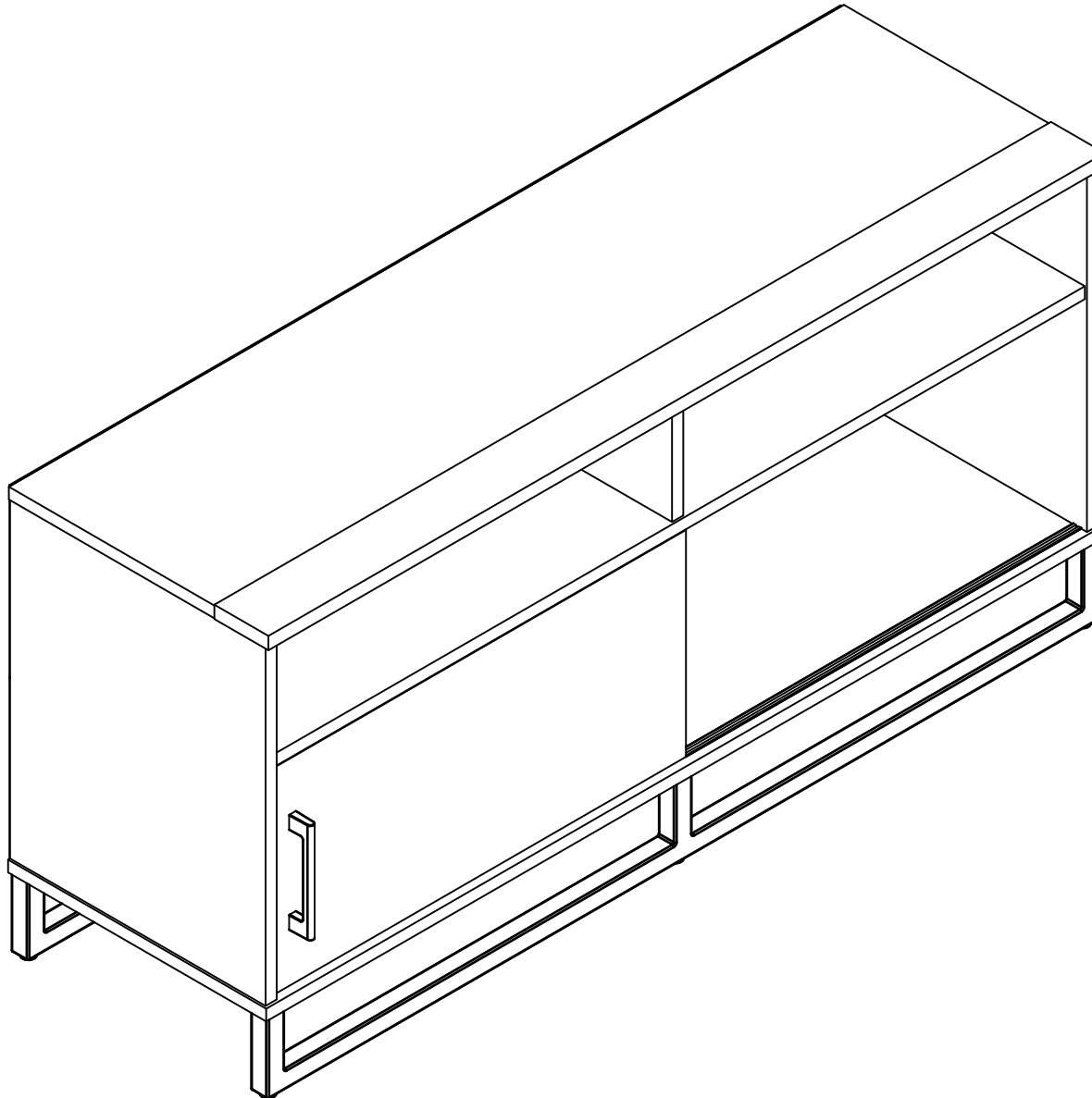

>> assembly instructions

B349144000T00



- Congratulations on your latest Target purchase.  
Now what? Don't start sweating over the box of parts. This will be easy. We did the hard work for you. All you need to do is follow our simple instructions and you'll be on your way to transforming your room in no time. Good luck--- though we're confident you won't need it.

## before you begin

1. Check for damaged or missing parts. Call 1-855-MYTGTHOME (855-698-4846) to order missing supplies.
2. Use the carton as a working surface to prevent product damage during assembly.
3. Gather all tools prior to assembly. Please do not use power tools.

## tools needed

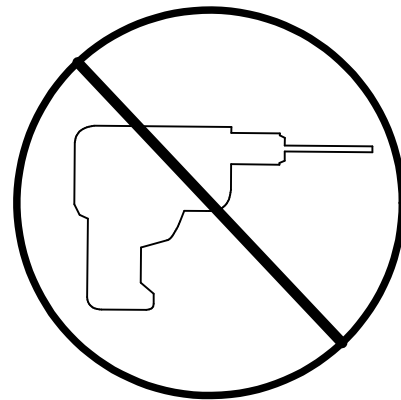
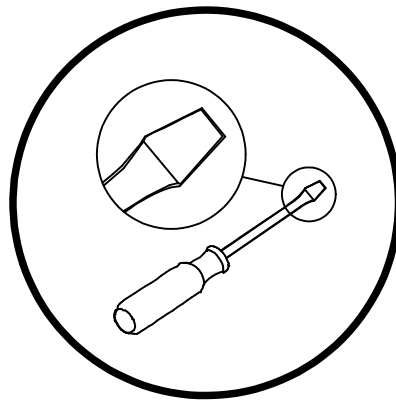
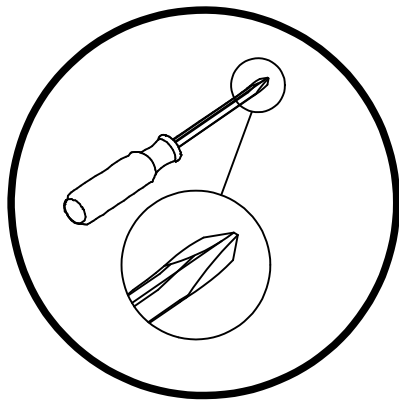
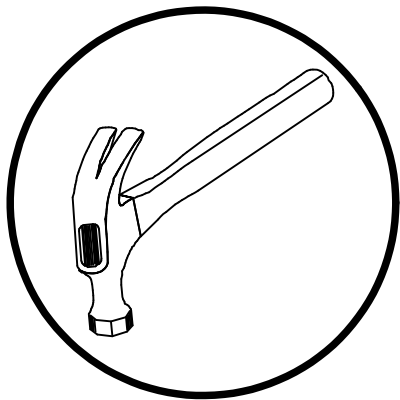

# table of contents

---

introduction	2
hardware	4
parts list	5
how to use the cam lock system	6
assembly	7-20

**"WARNING** - Death or serious injury may occur when children climb on audio and/or video equipment furniture. A remote control or toys placed on the furnishing may encourage a child to climb on the furnishing and as a result the furnishing may tip over onto the child."

**"WARNING** - Relocating audio and/or video equipment to furniture not specifically designed to support audio and/or video equipment may result in death or serious injury due to the furnishing collapsing or over turning onto a child."

**QUESTIONS?** Just call 1-855-MYTGTHOME (855-698-4846) for parts and service. For faster service, have the style number and DPCI number ready when calling.

# hardware

(1) x15  
cam lock  
#A22620



(2) x15  
cam bolt  
#A22610

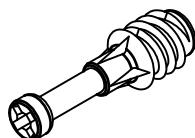

(3) x10  
wood dowel  
#A21660

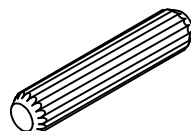

(4) x8  
confirmat screw  
#A23030



(5) x40  
nail  
#A21110

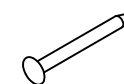

(6) x10  
#6x7/16" flat head screw  
#A11080

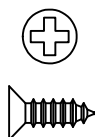

(7) x14  
#10x1/2" pan head screw  
#A14220

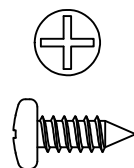

(8) x2  
#8-32x7/8" bolt  
#A17400

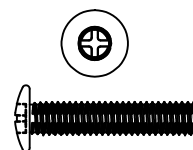

(9) x1  
handle  
#A50415

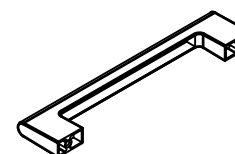

(10) x2  
door track  
#A82820

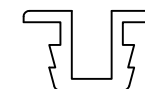

(11) x2  
roller guide  
#A71870

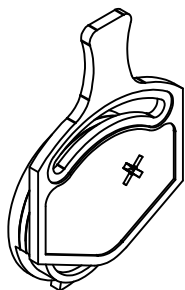

(12) x2  
upper guide  
#A71880

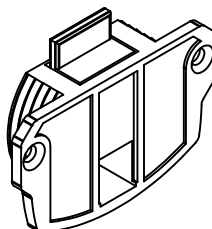

(13) x1  
tv warning label  
#B64355

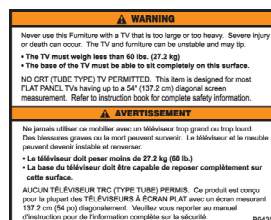

(14) x2  
metal leg  
#A95530

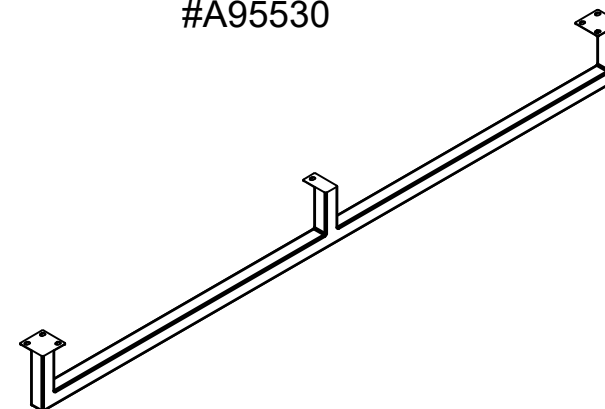

**Note that your unit may contain extra hardware**

Parts shown are the base cabinet of your model. Please note, most parts are labeled with a sticker or have a letter stamped on a raw edge.

This piece is paperboard construction. It is not made from wood but is required for assembly of your unit.

Parts List			
ITEM	QTY	PART NUMBER	DESCRIPTION
A	1	39144307010	LEFT PANEL
B	1	39144307020	RIGHT PANEL
C	1	39144307030	UPPER PARTITION
D	1	39144307040	LOWER PARTITION
E	1	39144307050	TOP
F	1	39144307060	BOTTOM
G	1	39144307070	SHELF
H	1	39144307080	TV RAIL
I	1	39144307090	DOOR
	1	K914430700	BACK PANEL

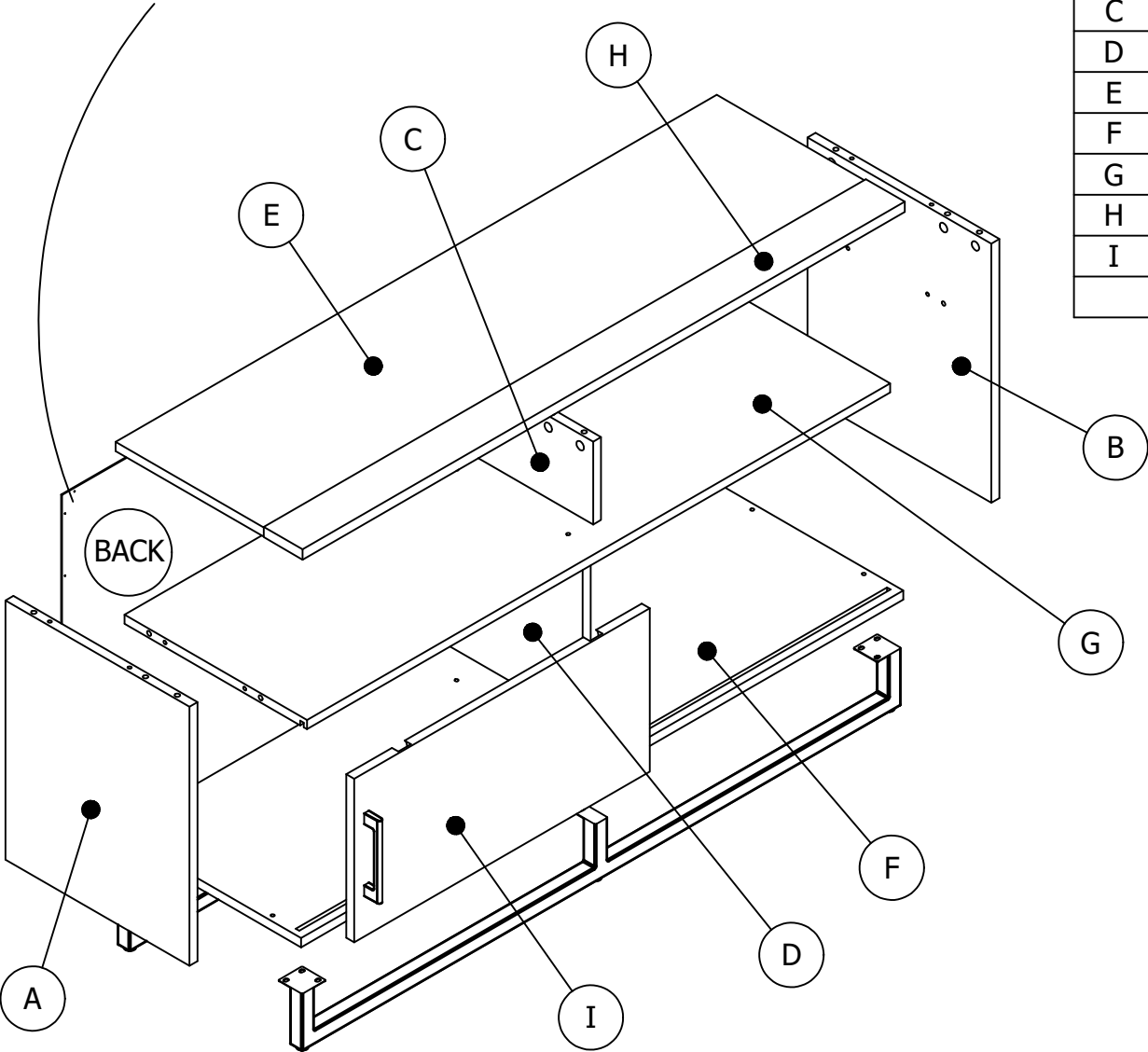

# how to use the cam lock system

---

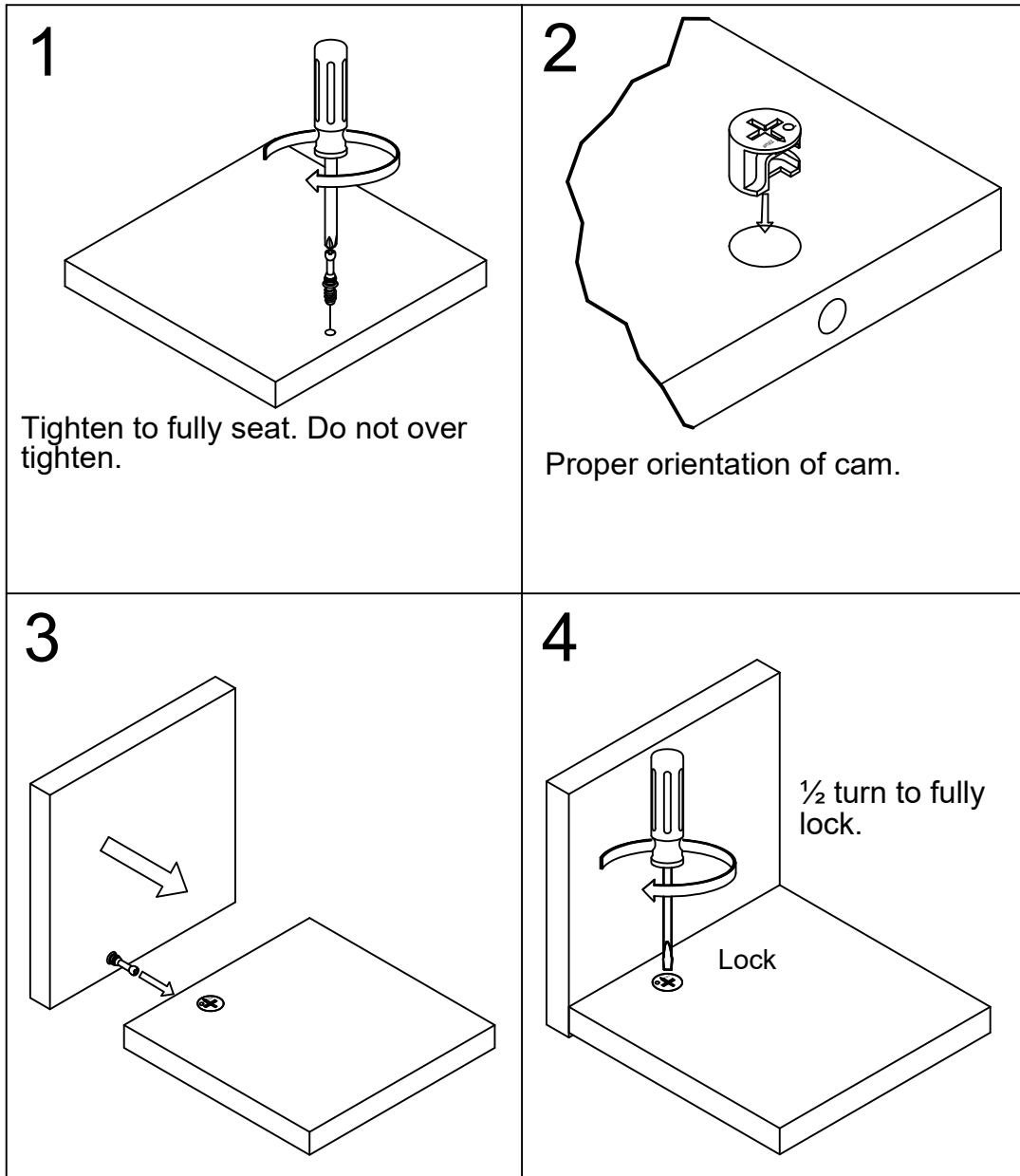

# step 1

---

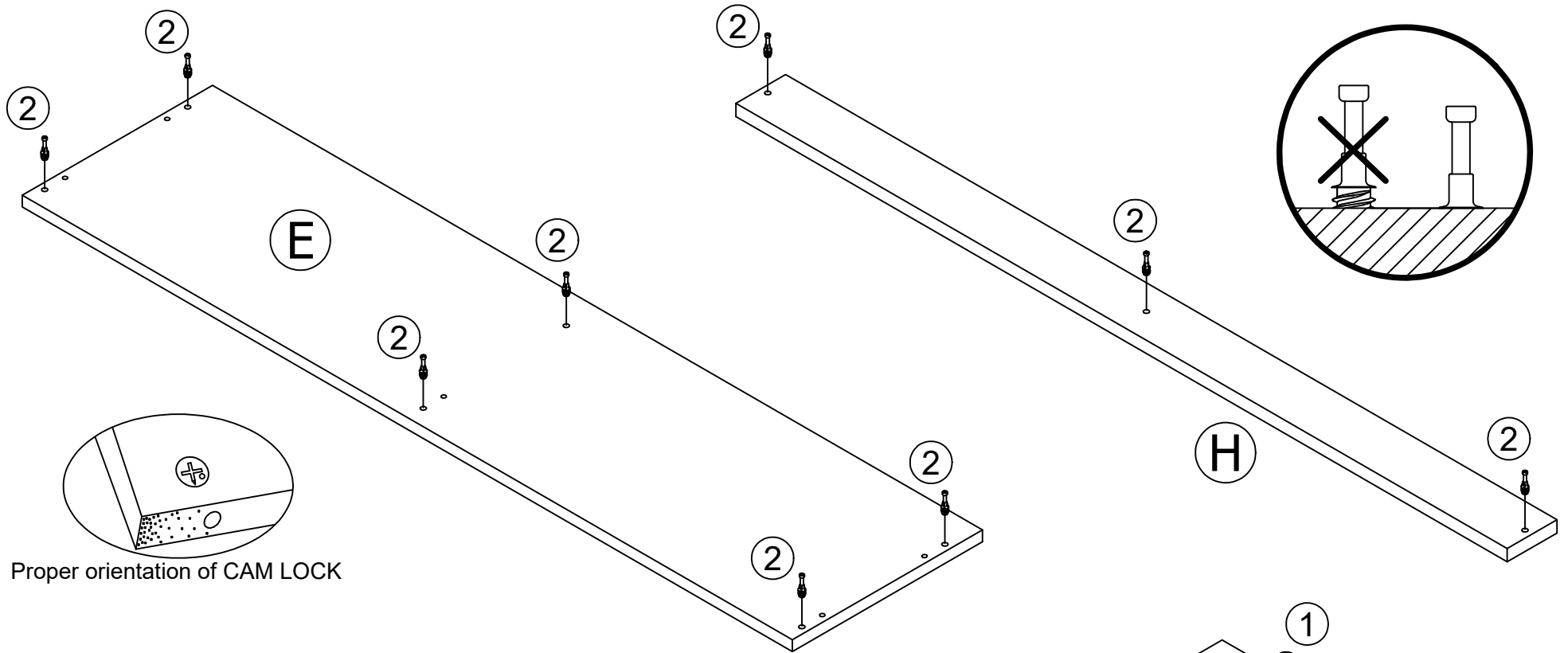

Proper orientation of CAM LOCK

---

(1) x3  
cam lock



(2) x9  
cam bolt

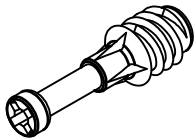

(3) x1  
wood dowel

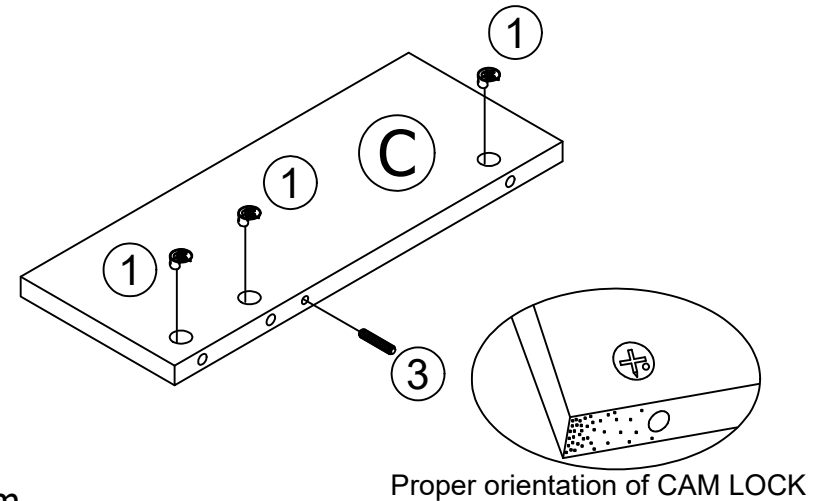
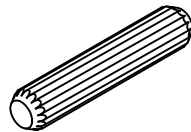

Proper orientation of CAM LOCK

1. Screw-in cam bolts must be screwed down flush.
2. Refer to page 6 for instructions on how to use the cam lock system.

## step 2

---

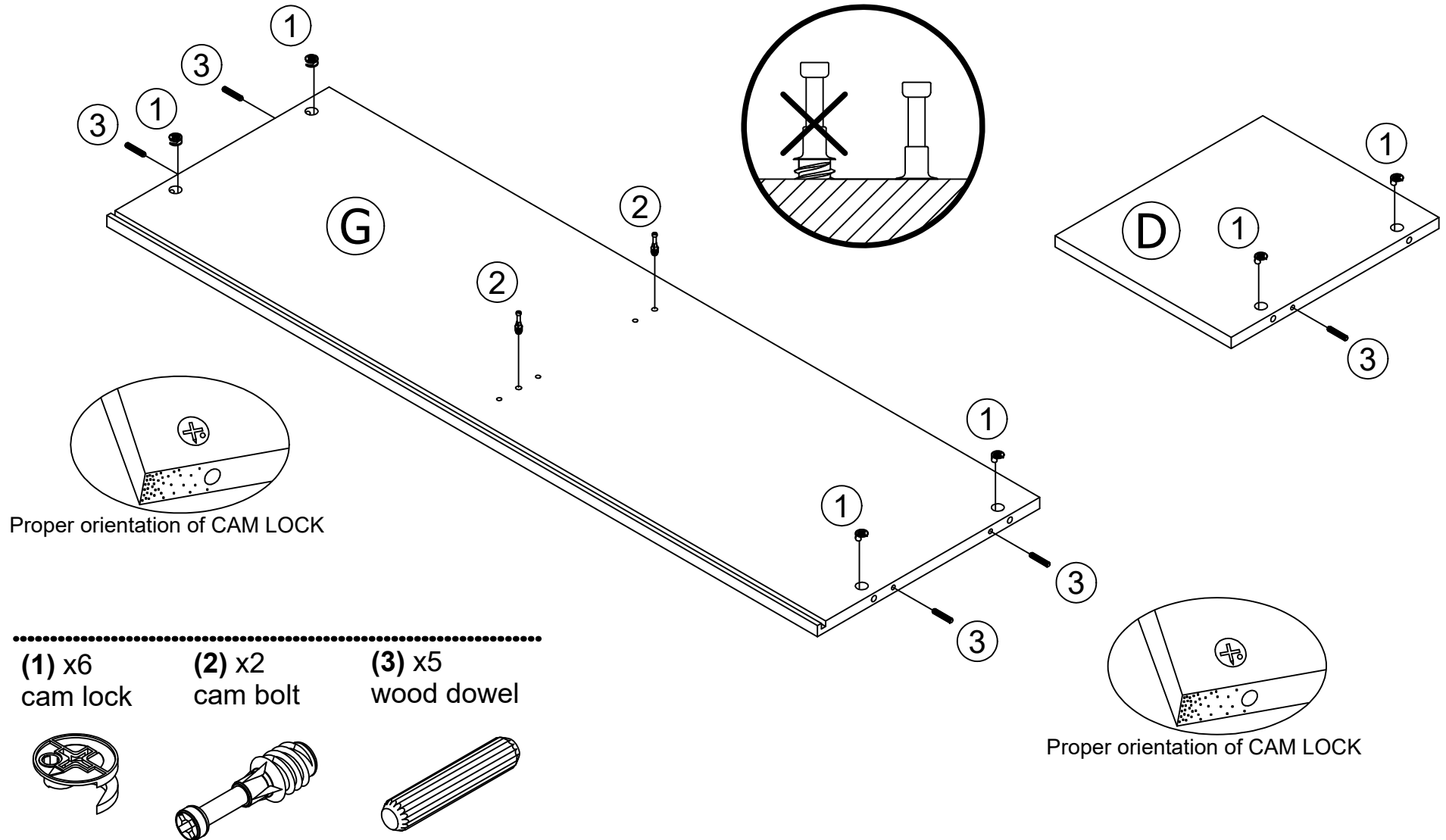

1. Screw-in cam bolts must be screwed down flush.
2. Refer to page 6 for instructions on how to use the cam lock system.

# step 3

---

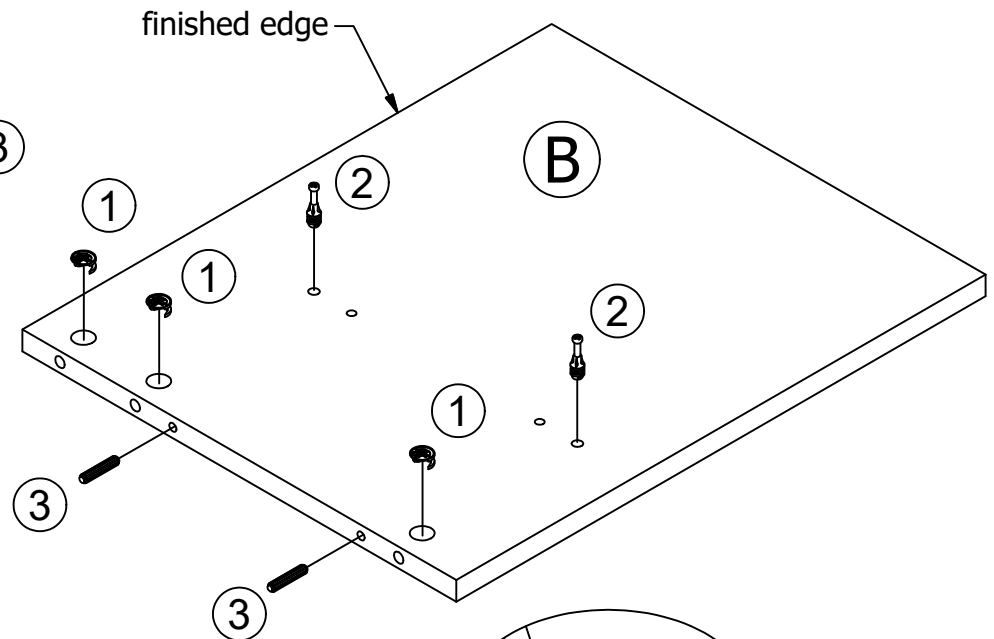
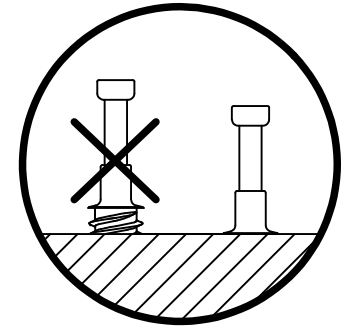
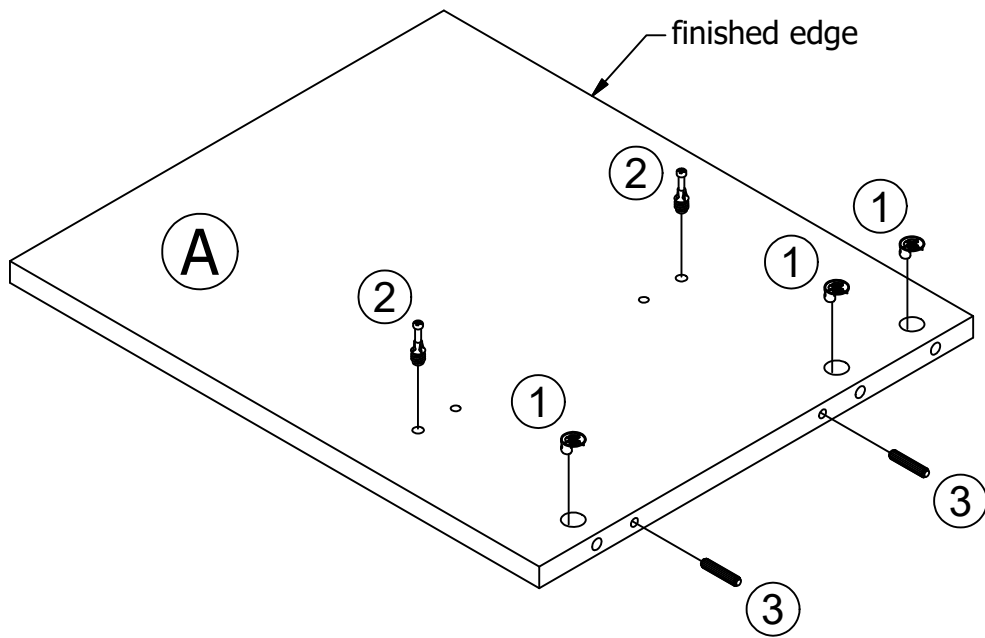

---

(1) x6  
cam lock



(2) x4  
cam bolt

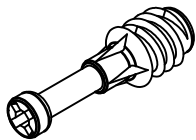

(3) x4  
wood dowel

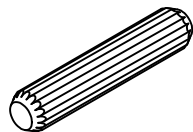

1. Screw-in cam bolts must be screwed down flush.
2. Refer to page 6 for instructions on how to use the cam lock system.



Proper orientation of CAM LOCK

## step 4

---

**1st**

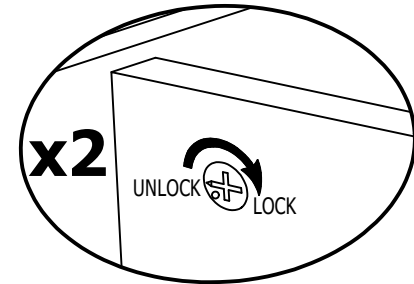
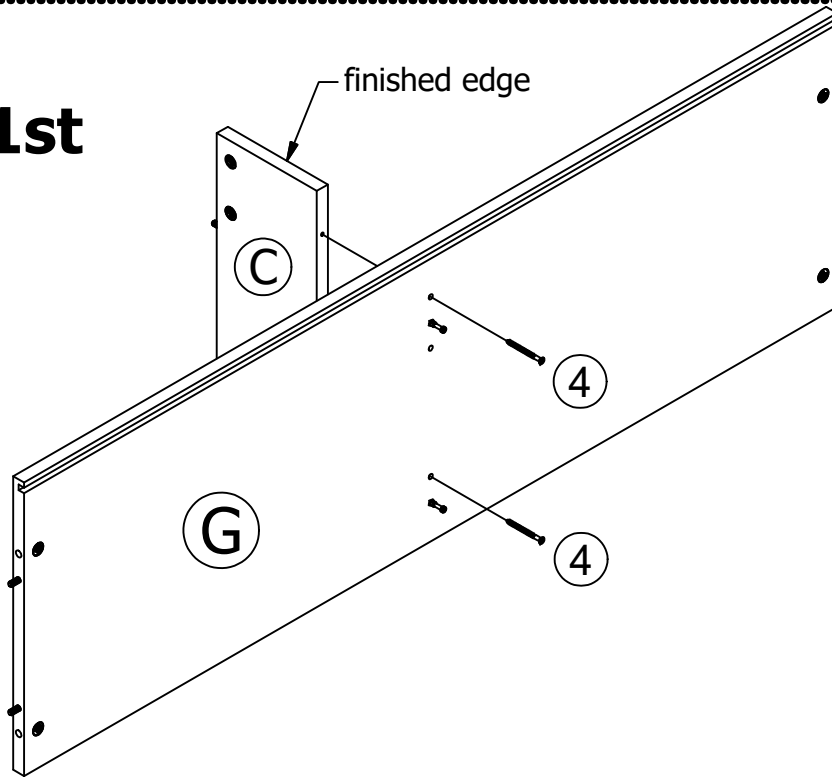

finished edge

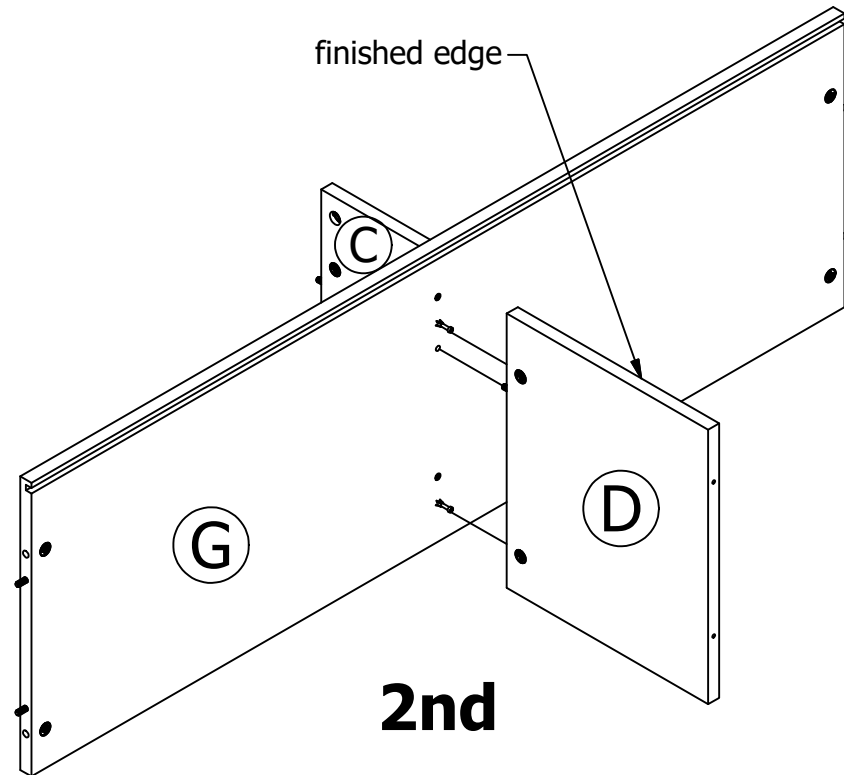

**2nd**

---

(4) x2

confirmat screw



1. Refer to page 6 for instructions on how to use the cam lock system.
2. Finished edge will face up.

## step 5

---

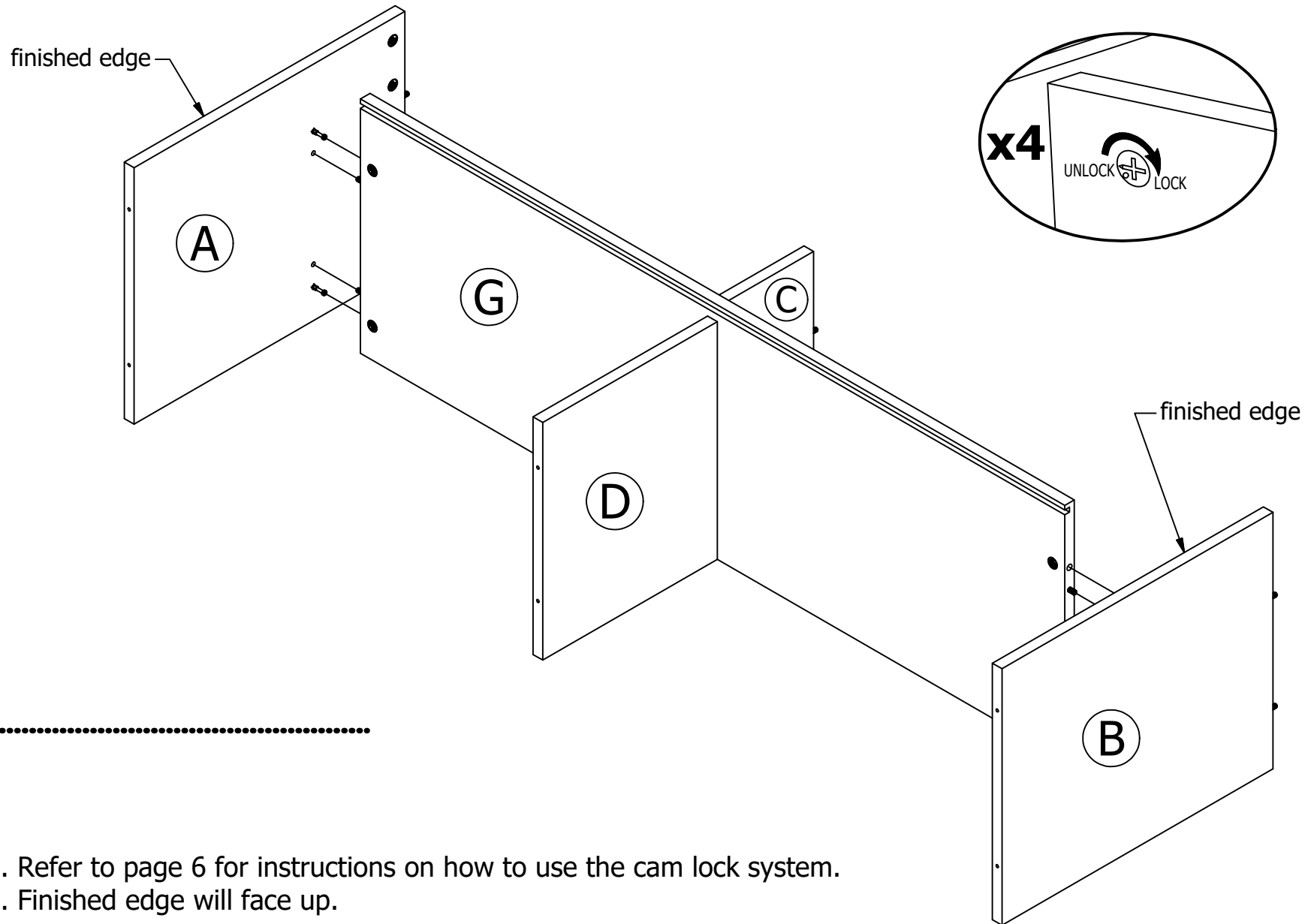

1. Refer to page 6 for instructions on how to use the cam lock system.
2. Finished edge will face up.

## step 6

---

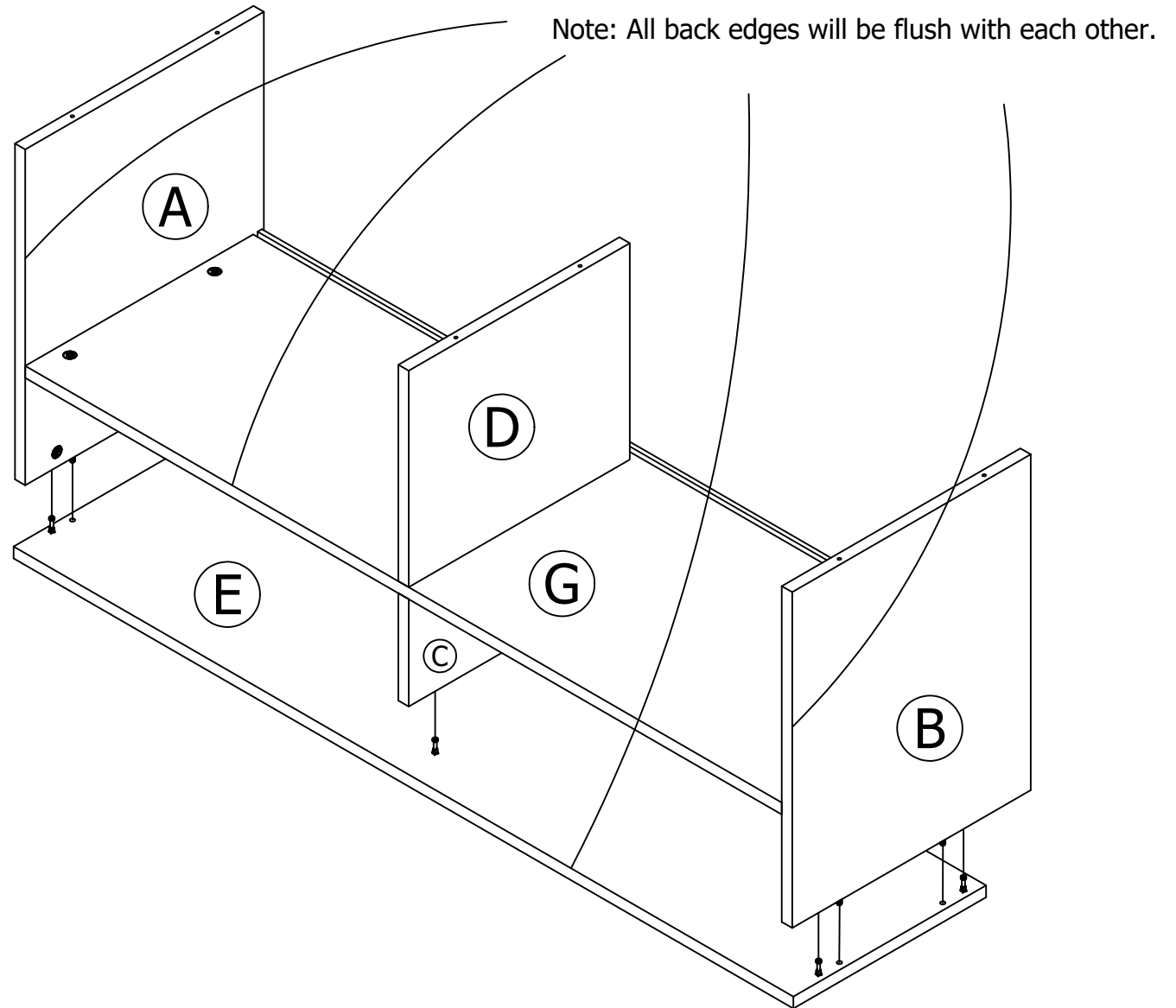
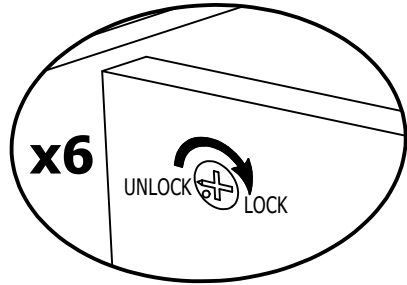

1. Refer to page 6 for instructions on how to use the cam lock system.

## step 7

---

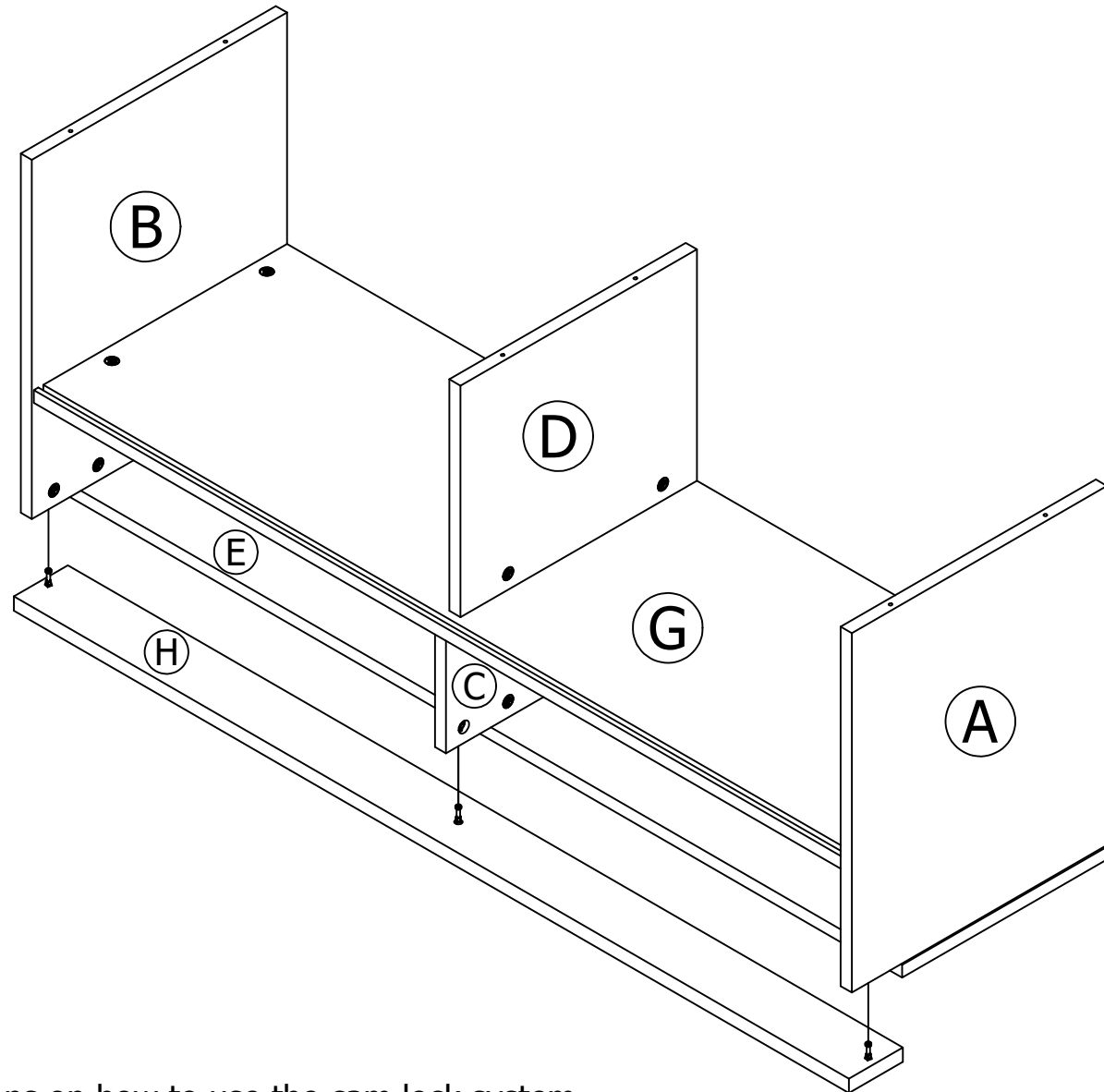
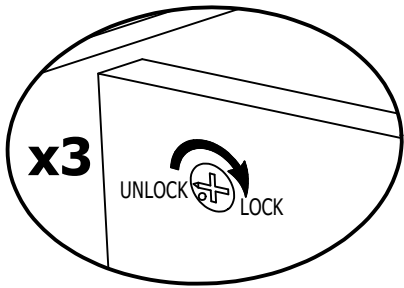

1. Refer to page 6 for instructions on how to use the cam lock system.

## step 8

---

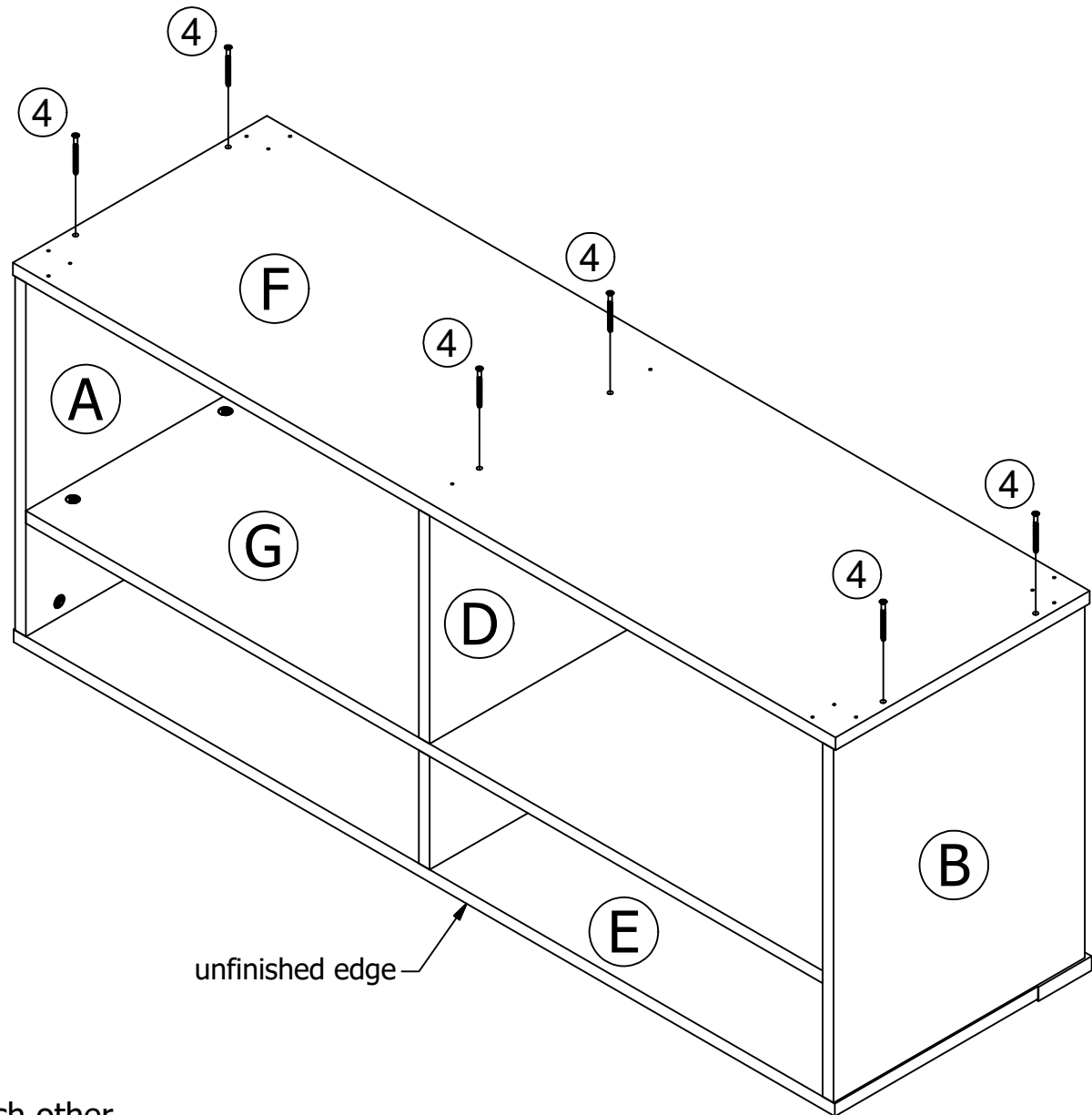

---

(4) x6  
confirmat screw



1. Unfinished edges to be flush to each other

## step 9

**IMPORTANT!** THE BACK PANEL IS A STRUCTURAL PART OF THIS UNIT AND MUST BE INSTALLED PROPERLY.

### WARNING

Please make sure that the Back Panel is attached securely. All nails must be driven into the parts straight and centered. Failure to do so could cause instability, product collapse, and/or serious injury.

Turn the unit onto its front.

**(5)** x40  
nail

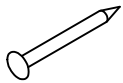

Attach the back panel so that the bottom edge is even with the bottom (F) and aligned side to side.

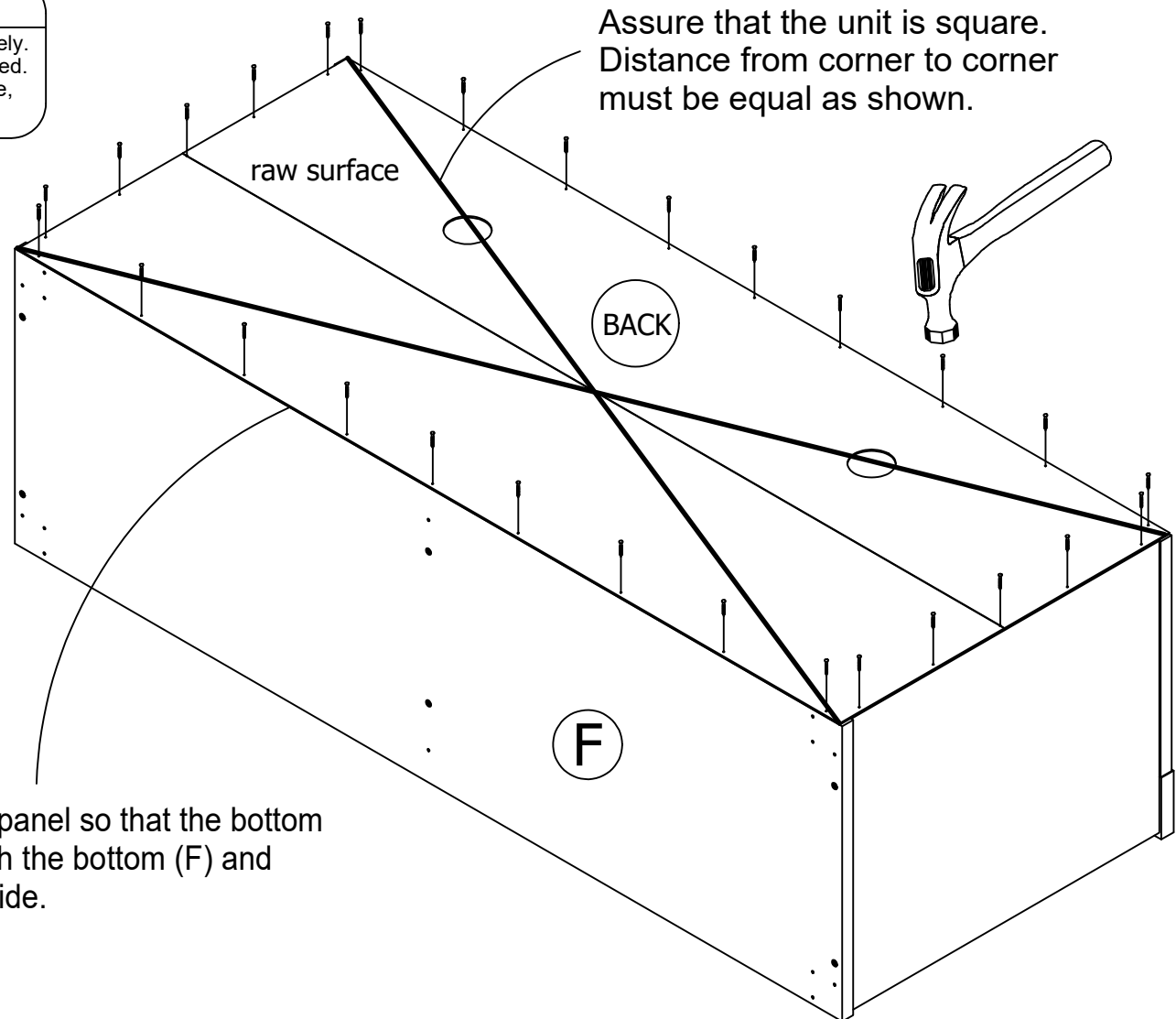

# step 10

---

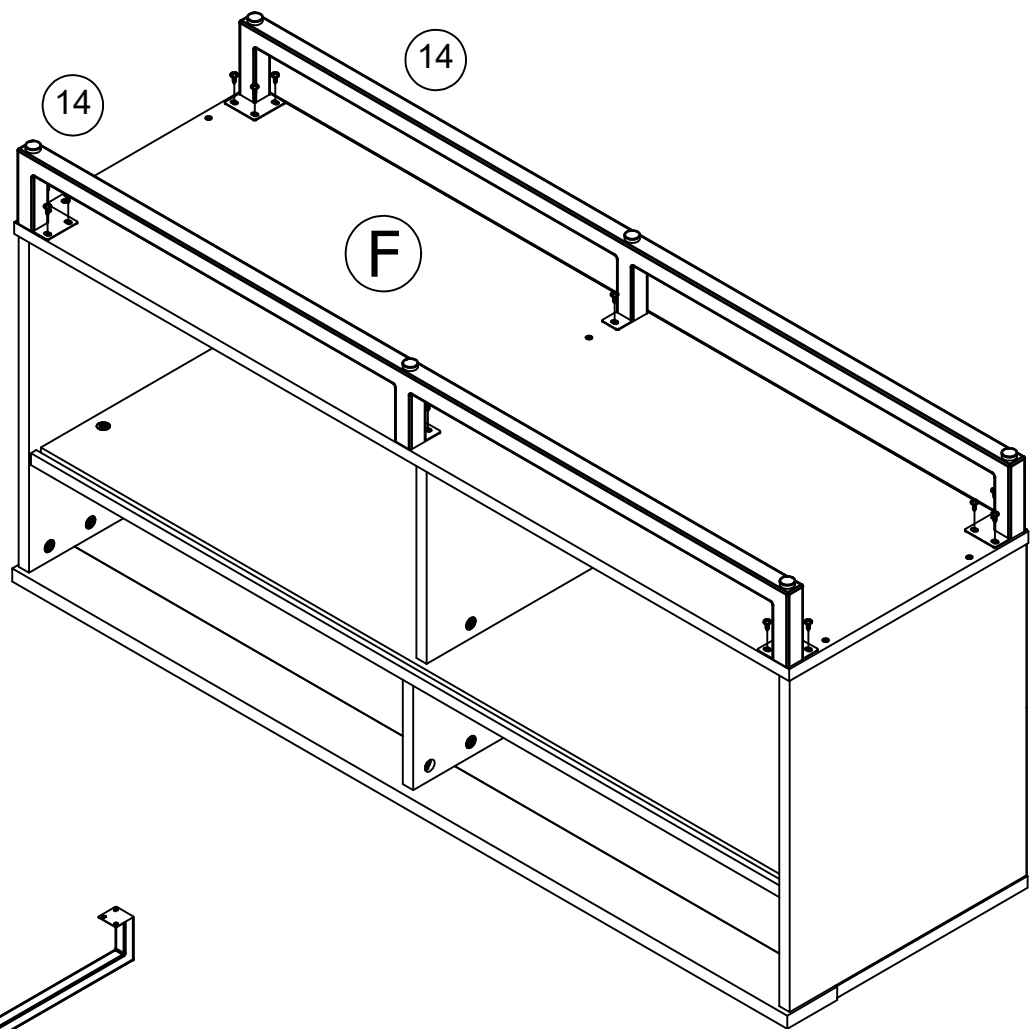
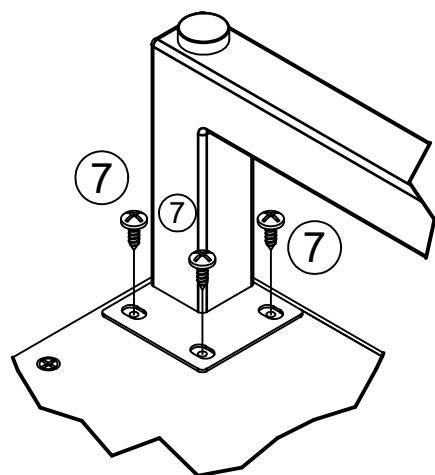

---

(7) x14  
#10x1/2" pan head screw

(14) x2  
metal leg

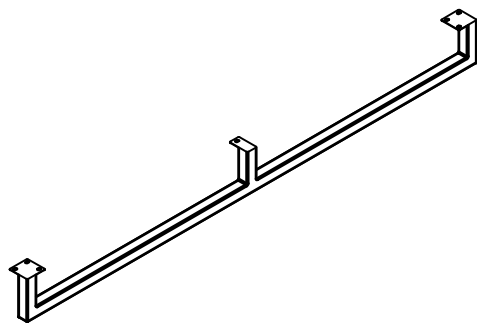
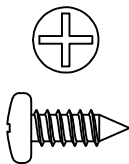

# step 11

---

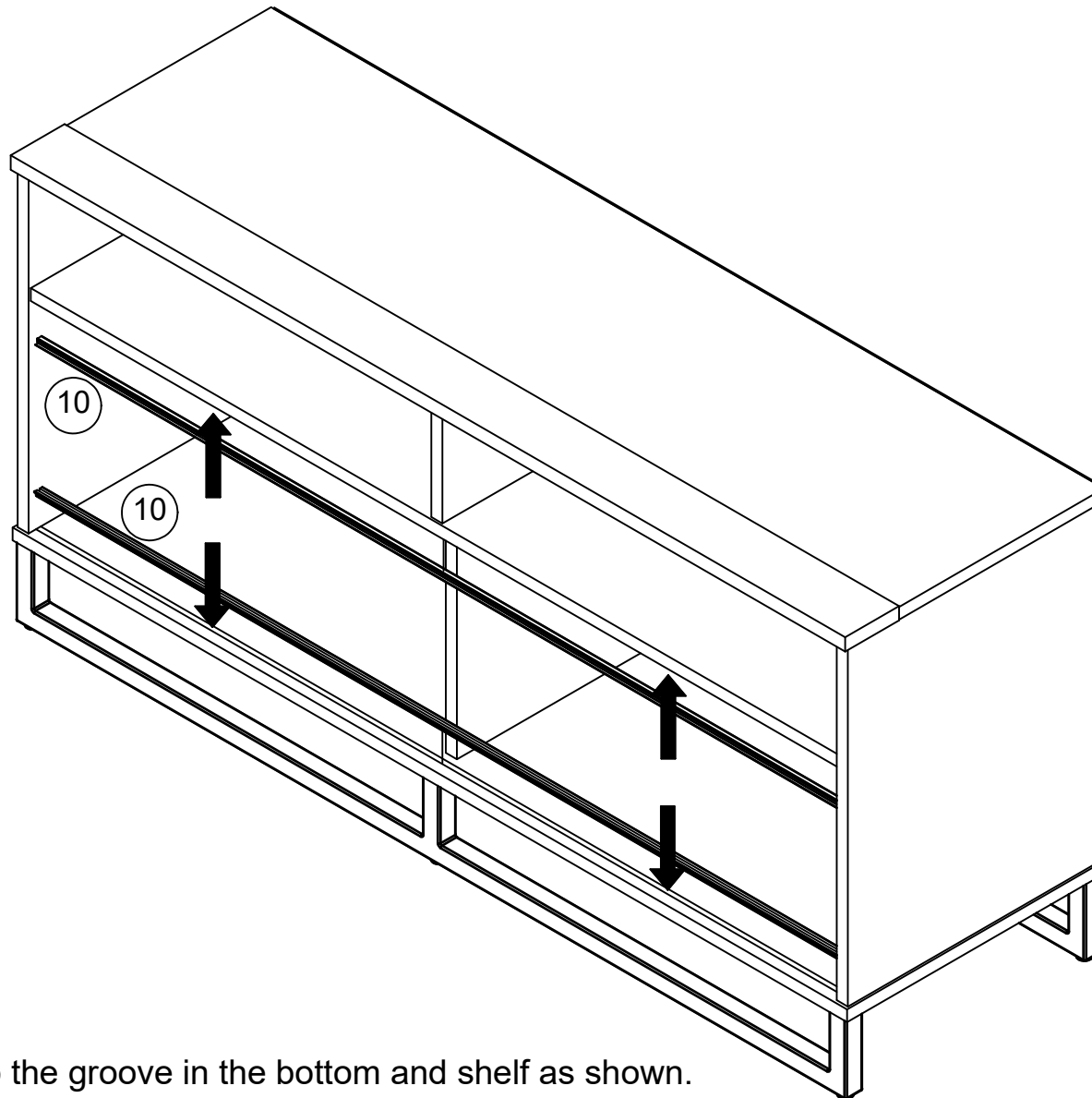

---

**(10) x2**  
door track

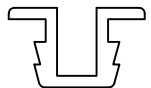

1. Press a door track into the groove in the bottom and shelf as shown.

## step 12

---

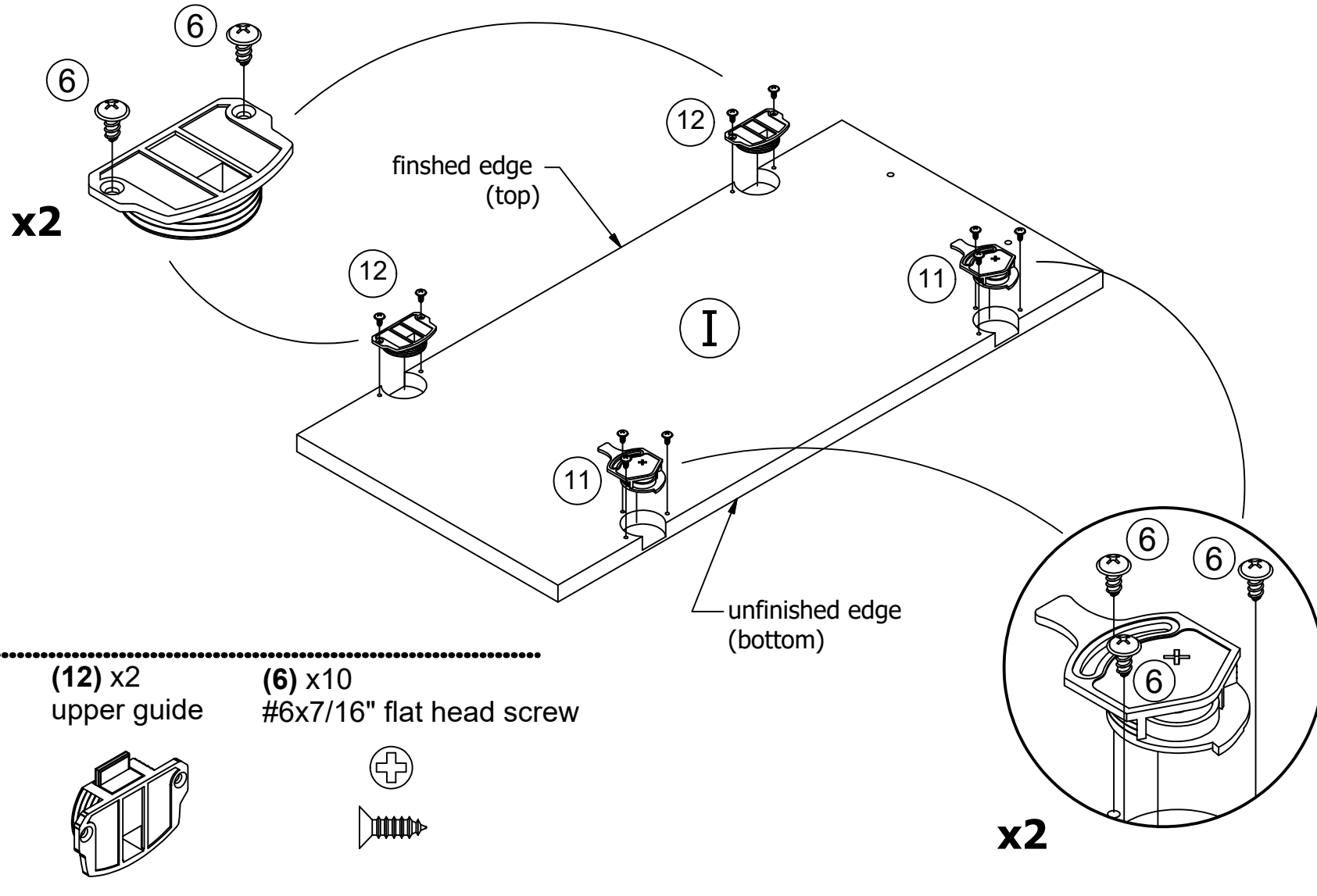

1. Do not overtighten these screws. Snug fit only.

# step 13

Be sure the guide stem is in the lower position before starting installation process.  
If not, press in with your thumb and slide down to the lower position as shown.

**Fig. 1**

Guide stem in the lower position

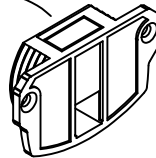

12



Guide stem in the upper position

Lower the guide stem in the upper door guide (12) as shown in Fig. 1.  
With the door slightly angled, position the door as shown.  
Insert door rollers (11) into the door track (Fig. 2) in the bottom (F).  
Lean the door inward until positioned over the shelf (G) groove.  
Press the guide stem in and slide up into the shelf (G) groove.

If needed, loosen screws, insert  
screwdriver here, and rotate roller.  
Turn clockwise will lower the door  
and counter clockwise to raise the door.  
Then retighten screws

Use this handle to raise or lower door.

This part will insert  
into the track.

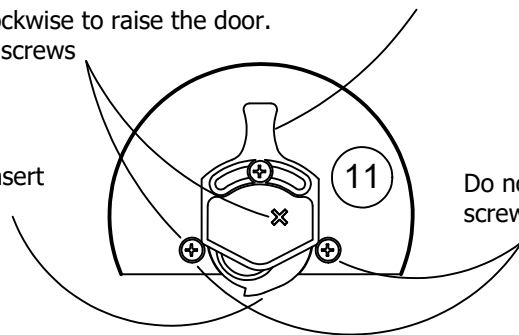

Do not overtighten these  
screws. Snug fit only.

The white roller will roll on  
the top part of the track.

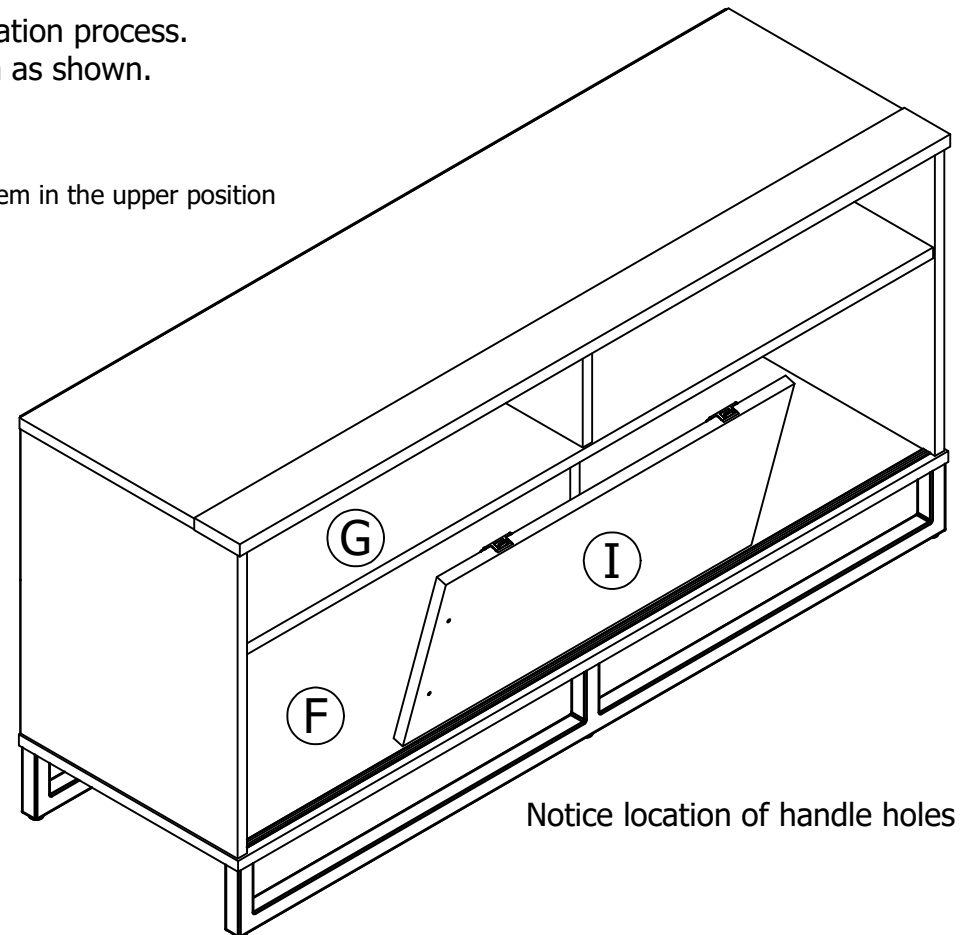

Notice location of handle holes

**Fig. 2**

This part of the roller  
inserts into the track

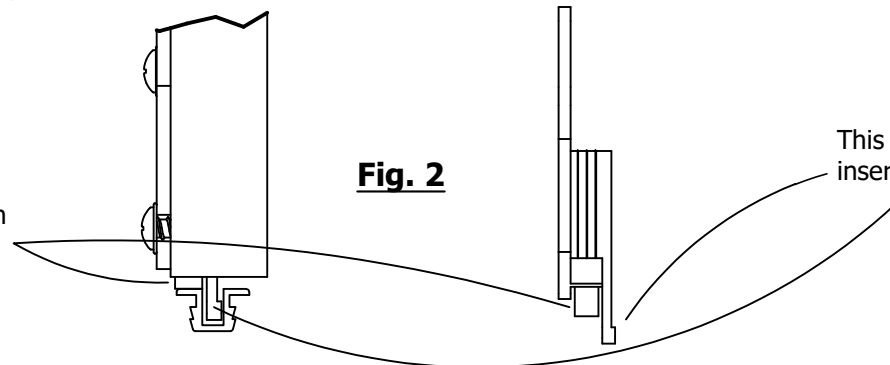

# step 14

---

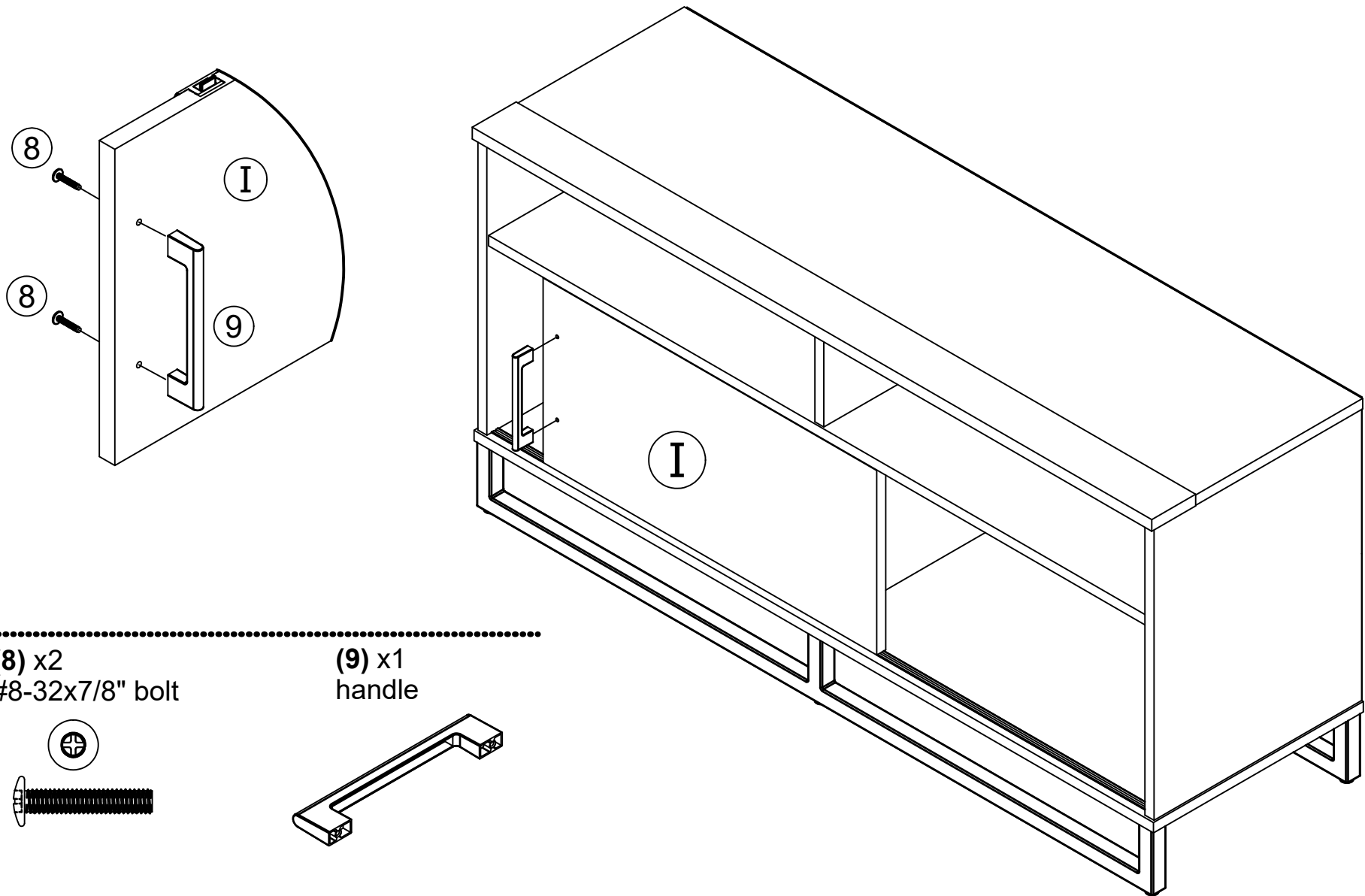

## MAXIMUM LOADS

This unit has been designed to support the maximum loads shown. Exceeding these load limits could cause sagging, instability, product collapse, and/or serious injury.

Note: This is a permanent label intended to last for the life of the product. Once applied, do not try to remove it.

Apply the WARNING LABEL (13) to the top. You should be able to read the label when the TV is removed from the unit. When the TV is in place, it should not hide the label. Peel off the backing and apply the label as shown.

Do not exceed over 60 lbs / 54" TV

<b>⚠ WARNING</b>
Never use this Furniture with a TV that is too large or too heavy. Severe injury or death can occur. The TV and furniture can be unstable and may tip.
<ul style="list-style-type: none"><li>• The TV must weigh less than 60 lbs. (27.2 kg)</li><li>• The base of the TV must be able to sit completely on this surface.</li></ul>
NO CRT (TUBE TYPE) TV PERMITTED. This item is designed for most FLAT PANEL TVs having up to a 54" (137.2 cm) diagonal screen measurement. Refer to instruction book for complete safety information.
<b>⚠ AVERTISSEMENT</b>
Ne jamais utiliser ce mobilier avec un téléviseur trop grand ou trop lourd. Des blessures graves ou la mort peuvent survenir. Le téléviseur et le meuble peuvent devenir instable et renverser.
<ul style="list-style-type: none"><li>• Le téléviseur doit peser moins de 27.2 kg (60 lb.)</li><li>• La base du téléviseur doit être capable de reposer complètement sur cette surface.</li></ul>
AUCUN TÉLÉVISEUR TRC (TYPE TUBE) PERMIS. Ce produit est conçu pour la plupart des TÉLÉVISEURS À ÉCRAN PLAT avec un écran mesurant 137.2 cm (54 po) diagonalement. Veuillez vous reporter au manuel d'instruction pour de l'information complète sur la sécurité.
B64355

